

THE

# Parish Pump

St Mary's ♦ Hemyock  
All Saints ♦ Culmstock  
St Andrew's ♦ Clayhidon  
Culm Davy Chapel

OCT ♦ NOV 2020



## ***In This Issue:***

CR2EE

Call for Veterans

LEAP News

'Shedders'

Clayhidon £10,000 grant

Rosemary Lane News

## Editorial Notice

The 'Parish Pump' is produced by the Churches of Hemyock with Culm Davy, Clayhidon and Culmstock for the people of the area. The views of contributors are not necessarily those of the Editors. The 'Parish Pump' accepts no liability for (i) any claims made by the advertiser (ii) any errors or omissions in any advertisement as submitted by the advertiser (iii) any legal action as a result of the advertisement.

The editor can be contacted via email on [pump@lickham.co.uk](mailto:pump@lickham.co.uk), or by telephone on 07763 855414.

## Church Contacts

### The Benefice of Hemyock with Culm Davy, Clayhidon and Culmstock

Mission Statement: To love God, and to love our neighbours

**RECTOR Rev Becky Totterdell** (available normally Tuesday, Friday and Sunday) 01823 681520

**ADMINISTRATOR Hilary Clements** (available Tues and Thurs 9.30am-12.30pm)  
ucvmission@gmail.com 07495 639826

#### ST MARY'S HEMYOCK

WARDENS	David Bawler, 4 South View	680352 / 07773579809
	Jenny Doble	680174
SERVICES	<i>For details please see inside</i>	

#### CULM DAVY CHAPEL

WARDENS	Mark FitzGerald	680564
---------	-----------------	--------

#### ST ANDREW'S CLAYHIDON

WARDENS	Stephen Bullett	680561
	Denis Sanders	601342

#### ALL SAINTS CULMSTOCK

WARDENS	Richard Preston	680216
	Carlie Salter	<a href="mailto:cjsalter2012@gmail.com">cjsalter2012@gmail.com</a>
		07450 996169

#### HEMYOCK BAPTIST CHURCH

SERVICES	<b>11.00am</b> and <b>7.00pm</b>	
	<b>11.00am</b> with Junior Church	
PASTOR	Steve Williams, 3 St Margarets Close	680946
SECRETARY	Mrs Maureen Aylwin	680111

#### ROSEMARY LANE CHAPEL, CLAYHIDON

SERVICES	<b>11.00am</b> Morning Worship followed by Bible Times for Young People & Adults	
	<b>6.30pm</b> Evening Service	
	<b>11.00am</b> Family Service – 3rd Sunday only	
PASTOR	Jonathan Hillman, 1 Blackdown Court, Clayhidon	681164
CONTACT	Gerald Redwood	680571

#### QUAKERS

Spiceland (Uffculme) Meeting House, Prescott EX15 3AZ

SERVICES	<b>10.30am</b> Meeting for Worship every Sunday	
	Children's meeting on 4th Sunday	
CONTACT	Pat Bell (Clerk)	01884 841375

#### METHODIST CHURCH

PASTOR	Revd Zdzisiu Hendzel 28 Rope Walk, Wellington	662724
CONTACT	Tony and Edith Butler	680441

#### R C CHURCH, CULLOMPTON

CONTACT	Fr Courtney	01884 32253
---------	-------------	-------------



## Half Moon Inn

### Clayhidon . Devon . EX15 3TJ

Tel: 01823 680291 [www.halfmoondevon.co.uk](http://www.halfmoondevon.co.uk)

### Welcoming our New Chef & New Autumn Menu

Following the success of the Government's Eat Out to Help Out Scheme we will be offering a new incentive to say a big Thank You for your continued support following these difficult times...

Well, you've heard of "Happy Hour", we're now introducing "Happy Days"! Dine in with us on any day of the week and get a discount voucher to use on your next visit. Between 10% – 25% off Voucher depending on which day of the week you choose to come in next time!

*For those concerned about being indoors, stay under cover in our beautiful Bedouin Tent and enjoy our stunning valley views!*



#### This Autumn/Winter look out for...

- Wine Tasting Evening
- Ladies' Night
- Friday Night Live Acoustic Music
- Quiz Nights

Follow us on Facebook for dates & all the Half Moon Updates!



## SMA Services Ltd

Member of the Institute of Certified Bookkeepers

Caring for Clients – Accounting for Business

Bookkeeping

Payroll

VAT Returns

Self-Assessment Tax Returns

2 Powells Way

Dunkeswell

Devon

EX14 4XL

Tel: 01404 891069

Email: [sonia@smaservices.co.uk](mailto:sonia@smaservices.co.uk)

Web: [www.smaservices.co.uk](http://www.smaservices.co.uk)

Director: Sonia Mogford-Abbott Cert.Acc. (Open); MICB; PM Dip.; SA Dip.; CB.Cert..



# ARBORICARE



LTD Est.1988

## TREE SURGERY

- FULLY INSURED
- ALL ASPECTS OF TREEWORK
- FELLING
- STUMP GRINDING
- FULLY QUALIFIED STAFF
- PRUNING AND MAINTENANCE
- PLANTING
- COUNCIL APPROVED
- POLLARDING
- ESTATE MANAGEMENT
- 24 HOUR CALL OUT

Call Colin Inder For Free Quotation

T: 01823 462972 M: 07831 108445

www.arboricare.co.uk • arboricare1988@gmail.com

## Windover Farm Cottage



Cosy country cottage (sleeps 4) located 1¼ miles from Hemyock village.

The cottage boasts two pretty bedrooms (one double & one twin), a luxurious bathroom, fully equipped kitchen and a large living area with a woodburner and a dining table to seat around 8 people.

Available for weekend, midweek and full week breaks.

For more information contact Sarah Machin:  
Email: sarahmachin@btinternet.com  
Tel: 01823 680611 Mob: 07977 141596

www.windoverfarmcottage.co.uk

## Regency House Bed and Breakfast



This wonderful 1855 house, once the Hemyock Rectory, sits in beautiful landscaped grounds with a walled garden and lake, just half a mile from the village pub, the Catherine Wheel.

Rooms are large, light and airy with wifi throughout, tea and cake on arrival, home made bread and marmalade, fruit compote, yoghurt and, of course bacon & egg for breakfast.

The garden, open under the National Gardens (yellow book) Scheme produces copious fruit and veg, Dexter cattle, Jacob sheep and horses live in our fields, tawny owls nest here, kingfishers, otters and herons fish the lake and our 30 acres are a haven of peace and Blackdown Hills quiet.

£50 per person  
wifi throughout

Jenny Parsons, Regency House, Hemyock EX15 3RQ  
01823 680238

www.regencyhousehemyock.co.uk



## Plumbing, Heating & Bathrooms

- Bathroom Refurbishment and Wet Rooms
- Oil and gas Boiler installations
- General Plumbing & Heating works

Tel: 07967 684804

Jack@arctaunton.com www.arcplumbingheatingsw.co.uk

Unit A, Blackdown Business Park, Wellington, Somerset TA21 8ST



## Blackdown Hills Business Association

The BHBA is a not-for-profit organisation proud to support businesses and help achieve a vital, vibrant, successful and sustainable economy within the Blackdown Hills.

### Membership includes:

- Professional advice, expertise and mentoring
- Sharing best practice across the parish network
- Business directory advertising
- Online promotional tools
- Interactive marketing campaign
- Regular business lunches with guest speakers
- Informal networking events
- Seasonal socials
- Flagship event - marquee at the Hontion Show
- Monthly e-newsletters
- Annual membership from £60 -Join today!



www.bhba.org.uk

Tel: 07826 581365

## PAINTING & DECORATING

By Robin Porch

Free Estimates  
& Advice

Quality Work Guaranteed

Tel: 01823 680739 or  
07973 839115

**125**  
YEARS  
1895 - 2020

Taking care of your loved ones with the dignity and respect that they deserve

# Pring & Son

**Hemyock Funeral Directors**  
Est 1895

4th Generation, Independent Family Business

A complete personal service to suit your wishes, arrangements can be made in the comfort of your own home.

**07860 390002**

24 hours a day

**01884 32855**

9am - 5pm Monday to Friday

Culmstock Road, Hemyock, EX15 3RJ

50 Fore Street, Cullompton, EX15 1LB

Local provider of Golden Charter Plans

pringandson@aol.com

www.pring-and-son-funeral-directors.co.uk



## C A HEARNE ELECTRICAL SERVICES

- FUSEBOARDS
- REWIRES / PART REWIRES
- EXTRA SOCKETS & LIGHT
- WIRING OF DOMESTIC HEATING SYSTEMS
- TESTING
- FAULT FINDING
- ALL ASPECTS OF WIRING

FULLY QUALIFIED & INSURED

PART P COMPLIANT

**CONTACT CHRIS HEARNE**

**TEL: 01823 681123**

**MOBILE: 07889474071**

**EMAIL: sid29@btinternet.com**

## LEGAL ADVICE IN HEMYOCK

For over 20 years the West Country firm of Milford & Dormor have been providing legal services in Hemyock from the sub-office at Halifax House, Hemyock (opposite the Village Hall).

Appointments can be made by telephoning **01460 61000** for a meeting in the office or home visit by appointment.

Ask for a **FREE** initial interview.

**Milford & Dormor**  
S O L I C I T O R S

**Tele: 01823 681300 (Hemyock) or 01460 61000 (Chard)**

Offices at: Axminster, Seaton, (Devon) or Chard, Ilminster (Somerset)

Authorised and regulated by the Solicitors Regulation Authority (SRA No 52245).

## BE AT ONE WITH NATURE

Communicating a love and awareness of nature through activities and experience.

- Woodland birthday parties
- Overnight camps
- Bushcraft and survival
- Team building

For individuals, families, school groups, corporate, Churches, Scouts and youth groups.

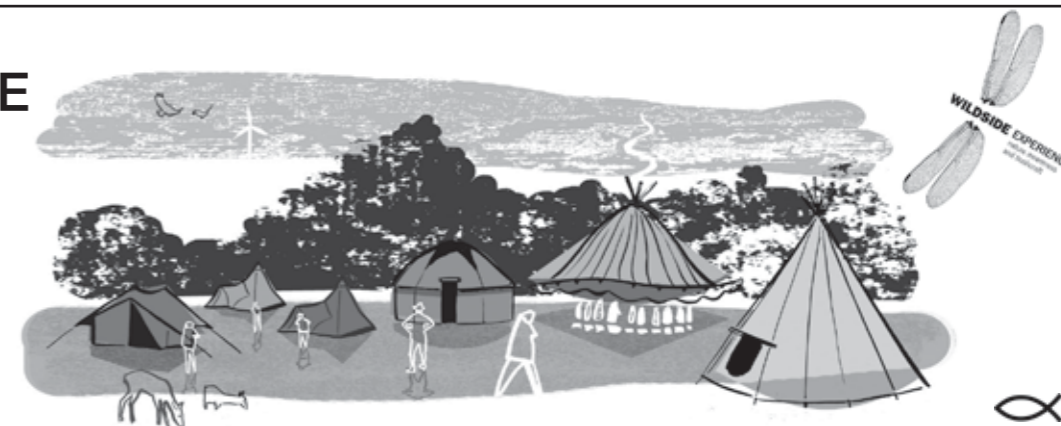

Contact Richard & Alison Whiteside

**01823 680931**

www.wildsideexperience.co.uk

## REDWOOD & SON

**FUNERAL DIRECTORS**  
FRENCH NUT TREE, CLAYHIDON

INDEPENDENT FAMILY BUSINESS

COMPLETE 24HR PERSONAL SERVICE

Telephone:

Gerald Redwood (01823) 680571  
Alan Redwood (01823) 680268

Trish  
Andrews



PERSONAL  
SERVICE

**BLACKDOWN RUG SERVICES**  
HORSE RUGS CLEANED & REPAIRED

Millview Cottage  
Clayhidon  
Cullompton  
EX15 3PN

Tel: 01823 681 453  
blackdownrugs@btinternet.com

KILN DRIED LOGS DELIVERED TO YOUR DOOR

Sustainably sourced, kiln dried logs. Less than 25% moisture



FREE LOCAL DELIVERY  
(within 15 miles of EX15 3PX)

- Wood-burning stoves
- Multi-fuel stoves
- Open fires
- Chimineas
- Wood fired ovens

Call or order online

01823 240 940

[www.thedrylogcompany.com](http://www.thedrylogcompany.com)

[info@thedrylogcompany.com](mailto:info@thedrylogcompany.com)



Find us on Facebook and Instagram

*From Tradition And Integrity Comes Peace Of Mind*

# WALTER H. SQUIRES & SON

3RD GENERATION FAMILY FUNERAL DIRECTORS, EST. 1933

*Cullompton's only third generation family funeral directors, still owned by its founding family and now under the care of husband and wife team Ryan and Melanie Squires.*

*A professional service at any time, day or night, trusted for nearly nine decades.*

*Local providers of Golden Charter Funeral Plans*



27 Higher Street, Cullompton, Devon,  
EX15 1AJ 01884 839556

Offices also at

11 Wellbrook Street, Tiverton, Devon, EX16 5JW 01884 252556  
29 Exwick Villas, Exwick Road, Exeter, Devon, EX4 2AS 01392 491556  
and 171 Pinhoe Road, Exeter, Devon, EX4 7HZ 01392 252556

[www.whsquires.co.uk](http://www.whsquires.co.uk)



## COTTRELL'S GARDEN CARE

**ALL ASPECTS OF GARDEN  
MAINTENANCE  
TREE WORK, LANDSCAPING  
AND FENCING UNDERTAKEN**

**COMMERCIAL AND  
DOMESTIC**

**FULLY QUALIFIED  
AND INSURED**



**Mob: 07919 838024**

[www.cottrellsgardencare.co.uk](http://www.cottrellsgardencare.co.uk)



### NEED TO REJUVENATE OLD METAL OBJECTS?

We provide a variety of services ranging from powder coating to hot zinc spray and shot blasting. We keep a range of about 100 colours in stock. Most are exterior polyesters, which provide excellent durability and colour retention on gates, railings and garden furniture.

[www.industrialcoatingsupplies.co.uk](http://www.industrialcoatingsupplies.co.uk)  
Phone 01884 34506  
Email [contact@industrialcoatingsupplies.co.uk](mailto:contact@industrialcoatingsupplies.co.uk)  
Monday-Thursday 8am-5pm  
Friday 7am -1pm



Units 1 + 2 Simmons Place, Kingsmill Industrial Estate,  
Cullompton, EX15 1BH

## Whiteball Self Storage



Insulated units of various sizes from 35 sq/ft  
Just £55.00 / Month Including VAT  
Limited open storage also available

Introducing **Store2Door**

Have an insulated 20' self storage unit sited at your premises for added convenience  
£90.40\* / month Inc VAT \*T&C's apply min 6 months

**5 Minutes from Junction 27 M5**

Please call us to discuss your self storage requirements

**T: 01823 674 129**

**W: [whiteball.co.uk](http://whiteball.co.uk)**

**E: [storage@whiteball.co.uk](mailto:storage@whiteball.co.uk)**



**ssa**  
self storage  
association  
United Kingdom

Greenham Business Park, Wellington, TA21 0LR

## No Vat !!

### APC Removals

Local & Long Distance  
Free Quotations & Advice



Tel: 01823 350512

Mobile: 07779037350

Web: [www.apc-removals.co.uk](http://www.apc-removals.co.uk)

Email: [a.p.c.removals@btinternet.com](mailto:a.p.c.removals@btinternet.com)

Taunton TA1 2TB



### Bespoke Soft Furnishings

Book an appointment  
by email or phone  
**Sue@SewingSue.co.uk**  
**01823 680169**

Look at fabrics in the comfort of your own home or visit me at Hemyock and Churchinford Markets; 1st and 3rd Saturdays in the month

**Sue Risdon**

# be inspired...



## THE OLD KENNELS

- Dunkeswell, Devon -

creative courses - arts, traditional crafts & skills in the beautiful Blackdown Hills, Devon

We host local, national and international tutors and provide a friendly, supportive atmosphere for your pure creative indulgence

[WWW.THEOLDKENNELS.CO.UK](http://WWW.THEOLDKENNELS.CO.UK)

4 STAR BED & BREAKFAST ACCOMMODATION AVAILABLE ALL YEAR

VIEW OUR FULL PROGRAMME OF COURSES ONLINE OR CALL FOR A BROCHURE



TEL: 01823 681138

# ASHCULME

TREE WORK | LANDSCAPING | FENCING | PAVING | MAINTENANCE



**TREE WORK** - ALL ASPECTS OF TREE WORK INCLUDING: REMOVAL, CROWNING & LIFTING

**STUMP GRINDING** - TOTAL REMOVAL OF ANY SIZED TREE STUMP

**LANDSCAPING** - ALL PROJECTS UNDERTAKEN

**FENCING** - NEW INSTALLATIONS OR REPAIRS TO EXISTING FENCES

**TURFING** - PREPARATION & LAYING OF YOUR NEW LAWN

**PAVING** - REPAIRS TO EXISTING PAVING OR COMPLETELY NEW INSTALLATIONS

**GARDEN MAINTENANCE** - HEDGE & SHRUB TRIMMING, FRUIT TREE PRUNING & MORE

FOR A FREE QUOTE FROM YOUR FRIENDLY, RELIABLE & ESTABLISHED LOCAL FIRM:

**CONTACT PAUL DURMAN 01823 353302**

EMERGENCY 24/7-  
**07815 146343**  
[www.ashculmetreesurgeons.co.uk](http://www.ashculmetreesurgeons.co.uk)  
[info@ashculmetreesurgeons.co.uk](mailto:info@ashculmetreesurgeons.co.uk)



Care, Compassion and Commitment



Save money and pay monthly for your pet's preventative care with our Pet Health Plans.

A simple, money-saving way to give your cat or dog the regular preventative treatments they need.

For full details visit us online or speak to a member of our team.

Cullompton  
01884 35558

Tiverton  
01884 258585

Honiton  
01404 44095

Uffculme  
01884 841317

[www.valeveterinarygroup.co.uk](http://www.valeveterinarygroup.co.uk)

## Emily's Unisex Hair Design

Culmstock Road  
Hemyock  
EX15 3RJ

### Opening Hours

Tue 9am-5.30pm  
Thu 9am-5.30pm  
Fri 9am-6pm  
Sat 9am-2pm

Late appointments available

Ring for an appointment  
**01823 681298**

### THE BLACKDOWN HILLS TRUST

The Blackdown Hills Trust is looking for local volunteers to help check stock fencing around the grazing units in the Neroche Forest area. These sites are managed by the Blackdown Hills Trust in the Blackdown Forest for grazing conservation: they are a magnet for rare butterflies such as Wood White and Duke of Burgundy and an array of plants, insects, birds and mammals. The areas are part of a Higher Level Stewardship and are grazed by English Longhorn cattle in the summer months.

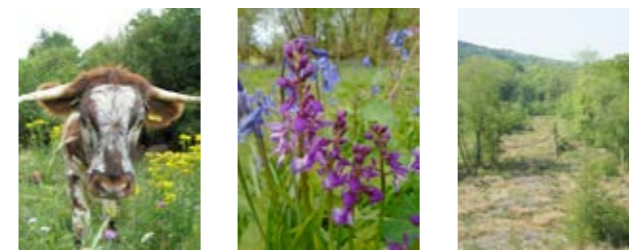

Duke of Burgundy and Wood White butterflies, just some of the species your work would help conserve. Image credits Peter Eeles, Butterfly Conservation.

#### What will the volunteer role involve?

The role will involve walking the stock fence twice a year during the spring and autumn in the grazing compartments to check for any rotten posts or damage to the wire, and reporting back to the Trust. There may also be opportunities to get involved in practical conservation work, for example clearing conifer re-growth to allow native flora to thrive.

Full training will be provided for the role, including maps of the sites, appropriate contact information and information on what to look out for.

Interested? Contact John Greenshields on 01823660764 or [parkfarmwoods@talktalk.net](mailto:parkfarmwoods@talktalk.net)

The Blackdown Hills Trust is a company limited by guarantee and registered in England no. 07181053. Registered Charity no. 1138327. Registered Office: c/o Park Farm, Wellington Somerset TA21 9NP

### Commercial Advertising

Advertisements are renewed on an annual basis commencing with the April edition. However, we do accept advertisements with each edition, if there is space. The charge will be on a pro-rata basis for the remaining editions before the next annual renewal. If you would like to place a commercial advertisement, please contact: [pump-adverts@lickham.co.uk](mailto:pump-adverts@lickham.co.uk).

Next deadline for enquiries: **1 March 2021** for the April 2021 edition.

### Ringborough Design and Planning

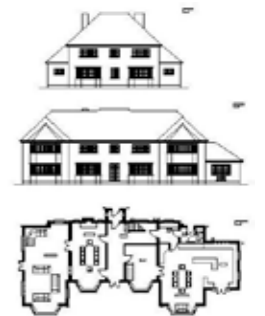

Helping you design your dream home

Guillaume Dijon  
Ringborough House  
Churchinford, Taunton TA3 7EB

Telephone: 01823 421 049  
Mobile: 07892 406 096  
Email: [gdijon@consultant.com](mailto:gdijon@consultant.com)



## Wild Service Tree Care

ALL ASPECTS OF TREE WORK – FELLING, PRUNING, SHAPING, PLANTING • HEDGE TRIMMING & LAYING SCRUB CLEARANCE • WOODLAND MANAGEMENT

*Fully insured • NPTC qualified*

Simon Higgins

w. wildservicetreecare.com

T. 07872 932512

E. simon@wildservicetreecare.com



## Andy Hayes general builder



exterior decoration and repairs service  
&  
All aspects of property maintenance

- Retaining Walls
- Extensions
- Garden Walls
- landscaping
- Traditional lime repairs
- Roof repairs & Cleaning
- Brickwork
- Stonework
- Blockwork
- Plastering
- Fencing
- Kitchens and Bathrooms
- Internal and external decorating
- Chimney repair
- Patios
- Alterations
- Guttering



**Qualified tradesmen  
over 25 years experience  
Free estimates**

**07792 251977 or 01823 430515  
andyhayesbuilder@yahoo.com**



all types of professional works  
carried out

## Joby Spencer

Hemyock Cullompton  
Devon EX15 3QP

tel: 01823 680 661

mob: 07790 836052

zsdecorators@hotmail.co.uk

## JON DAGGER

### Cooker / Kitchen

### Appliance Engineer

Over 35 years experience with many manufacturers inc. Rangemaster, Hotpoint, Cannon plus most others.

Repairs to Range type or built in or freestanding cookers, washing machines, dishwashers

**07725 852322**



## CULM PYNE LIVERY



ARE YOU LOOKING FOR LIVERY FOR YOUR HORSE?

DIY or Part Livery available

'American Barn' style stables

Small friendly yard with spacious stable, tack and feed stores. Plenty of summer and winter grazing on good quality, fresh pasture, Outdoor ménage with lights.

Big Bale Haylage for sale

Contact Cath on 01823 681018



**KEITH  
FARMER**  
BUILDING SERVICES LTD

## KEITH FARMER BUILDING SERVICES LTD

- ARCHITECTURAL DESIGN • PLANNING & DEVELOPMENT •
- BUILDING REGULATIONS • BUILDING CONTRACTORS • PROJECT MANAGEMENT •
- New Builds/ Conversions/ Extensions/ Commercial/ Industrial/ Listed Buildings •

**FREE INITIAL ADVICE AND ESTIMATE**

**01823 666223**



www.keithfarmer.co.uk



# NEED HEATING OIL?

*Then ring the local experts!*

## MONUMENT FUELS.

**FAST DELIVERY AND COMPETITIVELY PRICED**

**KEROSENE, RED DIESEL & BOTTLED GAS**

*Also available to collect from our yard pump weekdays 8am to 5pm*

**01823 650999**

Foxmoor Business Park, Chelston, Wellington, TA21 9RF

# Blackdown Chiropractors

TREATING PEOPLE & THEIR PETS

## Within the Healthy Living Centre Hemyock.

Chiropractic is a drug free way to treat aches and pains and problems related to the joints, muscles, nerves, ligaments and tendons. Treatment is suitable for all ages and is combined with advice on lifestyle and exercise to help manage the condition and to prevent its recurrence in the future.

Conditions Treated include:-

- Backpain - muscle strain, joint sprains, rib pain or sciatic pain
- Neckpain - stiff neck, torticollis, muscle spasm, whiplash injuries, referred pains.
- Elbow Pain - tennis or golfers elbow
- Knee pain - sprains, arthritic type pains, patella tracking problems
- Shoulder problems - tendinitis, rotator cuff injuries, frozen shoulder
- Hip problems - piriformis syndrome, muscle dysfunction
- Others such as - wrist pain, ankle sprains, plantar fasciitis

I am always happy to discuss problems or give talks to local groups.

Animals also benefit from treatment. I trained with the International Academy of Veterinary Chiropractic whose courses are only open to veterinarians and chiropractors to ensure a high quality of care. Although mainly horses and dogs are treated, other animals are considered on an individual basis.

Please call 07534222031 or go to [blackdownchiropractors.co.uk](http://blackdownchiropractors.co.uk) to book an appointment or to discuss how we may help you.



**VALE**  
veterinary group

Cullompton 01884 35558  
Taverton 01884 258585  
Horiton 01404 44095  
Lifton 01884 841317

**Is Your Pet Aged 9 or Over?**

We offer a free 'Creaky Club' nurse check, where we will examine your pet for signs of disease, to include a urine and blood pressure test.

Please contact us for more information.

Care, Compassion and Commitment

[www.valeveterinarygroup.co.uk](http://www.valeveterinarygroup.co.uk)

## CLEAN SWEEP

### CHIMNEY AND FLUE CLEANING



Brush and Vacuum service  
Clean, Friendly and Reliable

Cooker and Boiler Flues  
Woodburners  
Open Fires

Call 01884 821297  
07773 618524

Visit [www.sw33p.com](http://www.sw33p.com)  
email [kevin@sw33p.com](mailto:kevin@sw33p.com)

Your local Independent Flooring Specialists.

## ALL FLOORS

Domestic & Commercial Flooring  
All types of flooring supplied and fitted.

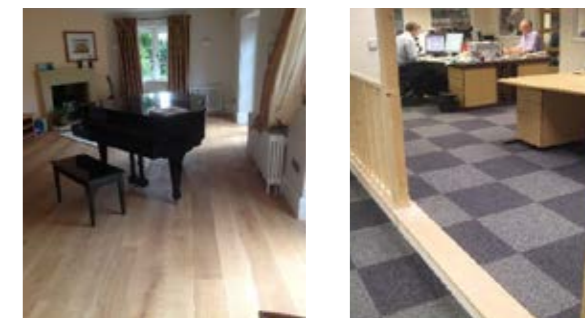

- Carpet & vinyl flooring
- Laminate and Hardwood floors
- Karndean and other LVT's

Tel. 01823 – 533025

Email – [allflooring@hotmail.com](mailto:allflooring@hotmail.com) or visit us  
At [www.allfloorings.co.uk](http://www.allfloorings.co.uk) to see more



## MONUMENT

### PLUMBING AND HEATING LTD

3 Higher Mead, Hemyock,  
Cullompton, Devon. EX15 3QJ

Telephone: 01823 680773



Domestic Plumbing Heating installation & servicing  
Oil, LPG and Natural Gas

Proprietor: Graham Webb Son: Darren Webb



## A.H. Electrical

All aspects of electrical work  
Local with good rates  
No call out fee  
Can work evenings  
and weekends

Please call **Antony** on  
**01823 680 865**  
**07967 321 007**

## G B Building & Maintenance

Conservation Builder  
Historic, Listed and  
Traditional Methods

Lime plastering  
Stonework  
Cob Walls  
Lime Wash paints  
Brickwork

Telephone:  
Mr Gary Broom on  
07776032289 or  
01823283212  
Listed Heritage Member

## BURNWORTHY LOGS

- Seasoned and dry hardwood.
- Multiple load sizes available.
- Kindling also available.

Contact Jake  
**01823 601588 - 07824 448719**  
[www.burnworthylogs.co.uk](http://www.burnworthylogs.co.uk)



**J.R. Ward Limited**  
**Building Services & Building Maintenance**  
 Inc. Plumbing, Heating & Electrical  
 Installations & Services

Registered Office: 3. Allens Well, Westleigh, Tiverton, Devon, EX16 7HP

Tel/Fax: (01823) 672087. Email: [wardjr@btopenworld.com](mailto:wardjr@btopenworld.com)

For all your Renewable Heating Requirements,  
 Mains Gas, L.P.G, Oil, Solid Fuel, Electric  
 Energy Performance Certificates carried out



152569

C.2606

Part P & Part L Registered

REGISTERED PLUMBER

**MANDY'S MOBILE  
 HAIRDRESSING**

FOR ALL YOUR HAIRDRESSING REQUIREMENTS.

20 YEARS EXPERIENCE.  
 TO MAKE AN APPOINTMENT  
 OR FOR MORE  
 INFORMATION PLEASE  
 CALL MANDY ON:-  
**01823 680996** or  
**07582810953.**



**KWS**  
 WOODBURNERS  
 Kevin Walker

**07896 282449**

- Stove Installation
- Servicing
- Power Sweeping
- Chimney Work
- Free Estimates

**DERBYSHIRE'S**  
*Village and Country*

Derbyshire's Estate Agents  
*The agent of choice for the Blackdowns*

Based in the heart of the Blackdowns in Hemyock, Derbyshires specialize in village and rural properties offering bespoke marketing solutions for individual properties

Sales – Residential , Equestrian, & smallholdings contact Marcus Bond MNAEA

Lettings – Residential & Commercial contact Paul Curtis MARLA

Derbyshire's Estate Agents  
 Halifax House  
 Station Road  
 Hemyock  
 EX15 3QW  
 Tel: 01823 681300

Email: [admin@derbyshires.net](mailto:admin@derbyshires.net)  
[www.derbyshires.net](http://www.derbyshires.net)

**VALLEY VIEW GARDEN SERVICES, HEMYOCK**

- Lawn Mowing & Hedge Trimming
- Maintenance & Clearance
  - Patio's & Fencing
- Friendly tidy service
  - Insured

Please call Roger on  
 07738 864146 / 01823 680567



**Carpet rug and upholstery cleaning**  
**Window cleaning**  
**Gutter cleaning**

From Wellington  
 Steve Wright  
 01823 666025 or 07860554753  
[stevewright87@hotmail.co.uk](mailto:stevewright87@hotmail.co.uk)



CREATING BEAUTIFUL SPACES  
 FOR YOU TO ENJOY



- GROUND WORK & CONSTRUCTION
- HARD & SOFT LANDSCAPING
- TERRACING, STAGING & DECKING
- PLANTING & PLANTING PLANS
- WALLING & FENCING
- TURFING
- WILDLIFE PONDS
- PATHWAYS & PATIOS



Call: Jonny Hodges 07841186750  
 Email: [info@livinglandscapessw.co.uk](mailto:info@livinglandscapessw.co.uk)

**P.R.O. DECORATING SERVICES  
 & house Maintenance**

Mob: 07718357483 Home: 01823 680006

Email: [poaten1962@hotmail.com](mailto:poaten1962@hotmail.com)

**Internal & External Decorating**

**Wallpapering**

**For A Free Estimate**

**Call Phil Oaten**

**35 Years Experience**

**BROADFIELD**

Garden & Patio  
 Maintenance  
 Services

- Grass Cutting
- Strimming
- Weeding

- Garden Waste Removal
- Autumn Leaf Clearing
- Hedge Trimming

- Pressure Washing
- Lichen Removal
- Patos and Driveways

- Decking
- Windows
- Conservatories

Email: [alan-fletcher1@hotmail.co.uk](mailto:alan-fletcher1@hotmail.co.uk) Mobile: 07564 513125 Telephone: 01823 680234

# Mount Vets

farm practice



It is our belief that a combination of good herd planning, routine monitoring and preventative medicine is the key to success on a modern farm.



Great value medicines delivered to farm!

Wellington Wiveliscombe Broadhembury

mountvets.com

- ✓ 11 Experienced Farm Vets
- ✓ Own Lab For Quick Results
- ✓ Regular Farm Skill Courses
- ✓ Positive Approach To Farm Health Management



Tel: 01823 662286

A Guardian Warm Roof will make a dramatic difference... THESE THERMAL IMAGES PROVE THE ADVANTAGES OF OUR ROOF SYSTEM

### BEFORE

Here's conclusive proof that the heat from this conservatory is evaporating through the roof - at an alarming rate.

Result: Impossible to keep warm in winter and at night. Plus, huge heating bills.

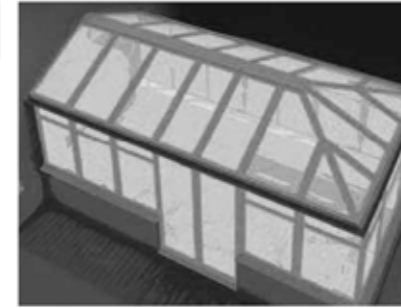

### AFTER

The same conservatory but this time the Guardian Warm Roof has replaced the glass roof and the heat loss is massively reduced.

Result: The room is now quiet and comfortable. An all-year-round living space!

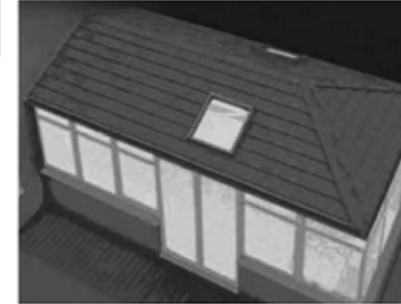

### OUTSIDE

Up until recently, this was a very basic lean-to conservatory with a polycarbonate roof.

Always cold in winter and far too hot during the summer months.

Now it looks more like a home extension, adding both style and value to this home.



### INSIDE

"It's now the conservatory we always wanted". That's what the homeowners said when they saw their new room.

Light, airy, safe and secure. The room has been totally transformed to become the perfect all-year-round living space.



A GUARDIAN WARM ROOF HAS THE POWER TO COMPLETELY TRANSFORM YOUR CONSERVATORY

UP TO 90% Saving on your heating bills!

- LOWER HEATING BILLS
- THERMALLY INSULATED
- LABC APPROVED
- COMFORTABLE & QUIET
- INSTALLED IN 4 DAYS
- CHOICE OF FINISHES



REQUEST A FREE HOME SURVEY, CALL: 01823 740 016 OR VISIT WWW.SOUTHWESTCONSERVATORIES.CO.UK

## FOUR SEASONS

PROFESSIONAL TREE SERVICES

All Aspects of Tree Surgery  
 Stump Removal  
 Crown Lifting Crown Reduction  
 Grounds Maintenance Grass Cutting  
 Hedge Cutting All types of Fencing  
 Wood Chip Seasoned Logs  
 General Garden Maintenance Turfing  
 Fully Insured Private & Commercial Customers  
 Free Quotations  
 www.fourseasons-treeservices.com  
 Oliver Vernon  
 info@fourseasons-treeservices.com  
 01884 563021/07766168162



BRIDGET'S  
 Flower Shed

Bespoke Flowers for All Occasions

Bridget Drew  
 t. 07803 582337/01823 681050  
 e. bridgetsflowershed@gmail.com  
 w. www.bridgetsflowershed.co.uk  
 f. Bridget's Flower Shed

LOCAL WHEAT + BARLEY

## STRAW

NO ROTARY COMBINED CROPS

ANY SIZE LOAD

PLEASE CALL FOR A COMPETITIVE DELIVERED PRICE.

MITCHELL PARTNERS

ORCHARD FARM

HILLCOMMON

JAMES 07799 261415

DAVID 07767 762241

## Services in the Upper Culm Valley Mission Community

A community of Faith, Hospitality and Inspiration  
Loving God and Loving our Neighbour

Visitors to, and residents of the area, are most welcome at the services throughout the Mission Community.

[www.culmkirks.co.uk](http://www.culmkirks.co.uk)

**Please do check notices outside the churches for up-to-date information about services. It is very likely that we will need to make changes as new government restrictions emerge. In particular, Remembrance Sunday services are likely to be entirely outdoors this year.**

BCP = Book of Common Prayer; CW = Common Worship

### OCTOBER 2020

	Sunday 4 October Trinity 17 St Francis		Sunday 11 October Trinity 18		Sunday 18 October St Luke		Sunday 25 October Last Sunday after Trinity Bible Sunday	
<b>Culm Davy Chapel</b>	09.00	Holy Comm BCP			3.30pm (Winter Time)	Evening Prayer BCP		
<b>St Andrew Clayhidon</b>	10.00	<b>FAMILY HARVEST</b>	8.30	Holy Comm CW			10.00 GMT	Holy Comm CW
<b>All Saints Culmstock</b>	10.00	Holy Comm CW	10.00	Ecumenical worship	10.00	Holy Comm CW	10.00 GMT	Morning Worship
			6.30	BCP Evensong				
<b>St Mary Hemyock</b>	11.00	Morning Worship	11.00	Holy Comm CW	11.00	Morning Worship	11.00 GMT	Holy Comm CW
			12.00	APCM				

**In addition:** A service is to be held each Tuesday morning at All Saints Culmstock at 10.00am. On the 4<sup>th</sup> Tuesday, **27 October**, it will be BCP Holy Communion; the remaining weeks BCP Morning Prayer.

### NOVEMBER 2020

	Sunday 1 November All Saints Day	Sunday 8 November Remembrance Sunday	Sunday 15 November 2 <sup>nd</sup> before Advent	Sunday 22 November Christ the King	Sunday 29 November Advent Sunday			
<b>Culm Davy Chapel</b>	<b>10.00 CULMSTOCK</b>		3.30pm (Winter Time)	Evening Prayer BCP	<b>10.00 CLAYHIDON</b>			
<b>St Andrew Clayhidon</b>		10.00	Holy Comm CW + Remembrance service	10.00		Morning Worship with Baptism of Lottie Devine	<b>St Andrew's Patronal Festival Holy Comm CW</b>	
<b>All Saints Culmstock</b>		10.15	Remembrance service	10.00		Holy Comm CW		<b>10.00 Morning Worship</b>
		6.30	BCP Evensong					
<b>St Mary Hemyock</b>	<b>4.30 HEMYOCK</b>	10.15	Remembrance Parade Service	11.00	Holy Comm CW	11.00	Holy Comm CW	<b>Evening Joint service to be confirmed</b>
	<b>Benefice All Souls' Thanksgiving</b>							

**In addition:** A service is to be held each Tuesday morning at All Saints Culmstock at 10.00am. On the 4<sup>th</sup> Tuesday, **24 November**, it will be BCP Holy Communion; the remaining weeks BCP Morning Prayer.

## Parish Pump | No. 281 October – November 2020



### Don't Worry About It

I am writing this a few days after having led my first service in church since March 15th. Even though it was lovely to see people in person instead of on my laptop screen via zoom, it still felt very strange and scary. I was having to concentrate not just on the service itself, but on taking all the necessary safety precautions as well. The thing which really came as a surprise after 35 years of taking services, was how nervous I felt. But in the end it was OK. It all worked, everyone was kept safe and as I went home afterwards I was thinking that we had taken a big step forwards into the new normality, and that no doubt we would soon get used to it, provided we don't have to go back into lockdown again!

***“We have all been given the opportunity to pause and think about what is really important in life.”***

If you cast your mind back to March, the idea of routinely wearing a face mask when we went into a shop, or walked along a busy street was something which simply would not have entered our heads. We had for some time seen images of people doing that in the in China and Japan, but it wasn't something we did in this country - well we do now! At least we do if we are being sensible. That was brought home to me quite dramatically back in August when I spent a weekend in South Wales with my daughter and son-in-law. Every time we went out we made sure, as a matter of course, that we had our masks with us. I was surprised that so few of the people we saw were wearing masks in shops, or taking any notice of social distancing guidance. Sadly, but not surprisingly, I see that there is now concern about rising infection rates just a few miles further West from where we were.

We cannot ignore coronavirus, it is going to be with us for a long time. We have to learn to cope with it, but we don't have to worry about it. The passage from chapter 6 of St Matthew's gospel, beloved of preachers at Harvest time, about 'consider the lilies of the field' springs to mind. It is all about not worrying over things. Worrying doesn't help. The last verse of that chapter reads, 'So do not worry about tomorrow, for tomorrow will bring worries of its own. Today's trouble is enough for today.' So don't worry about coronavirus. Take sensible precautions, stick to the rules and give thanks to God that as well as all the awful things the pandemic has caused, there are good things as well.

We have all been given the opportunity to pause and think about what is really important in life. We have learned to be much more appreciative of the people who work in the NHS and the emergency services. We have seen communities pulling together and people being more concerned about their neighbours. This might just be the beginning of a more caring society. We have had to find different ways to worship together when we couldn't use our church buildings. This could be the beginning of a whole new way of reaching out to people who have not in the past been attracted to coming to church. We have seen dramatic reductions in the amount of greenhouse gases produced. This could be just the encouragement needed to kick-start some really effective action on climate change. As my army officer daughter might say, 'Keep calm, don't worry, just crack on with making it happen.'

 Upper Culm Valley Mission Community is now on Facebook!

# St Mary's Hemyock

## In This Issue:

- ◆ Tea at the Rectory
- ◆ CR2EE
- ◆ Call for Veterans
- ◆ LEAP News
- ◆ 'Shedders'

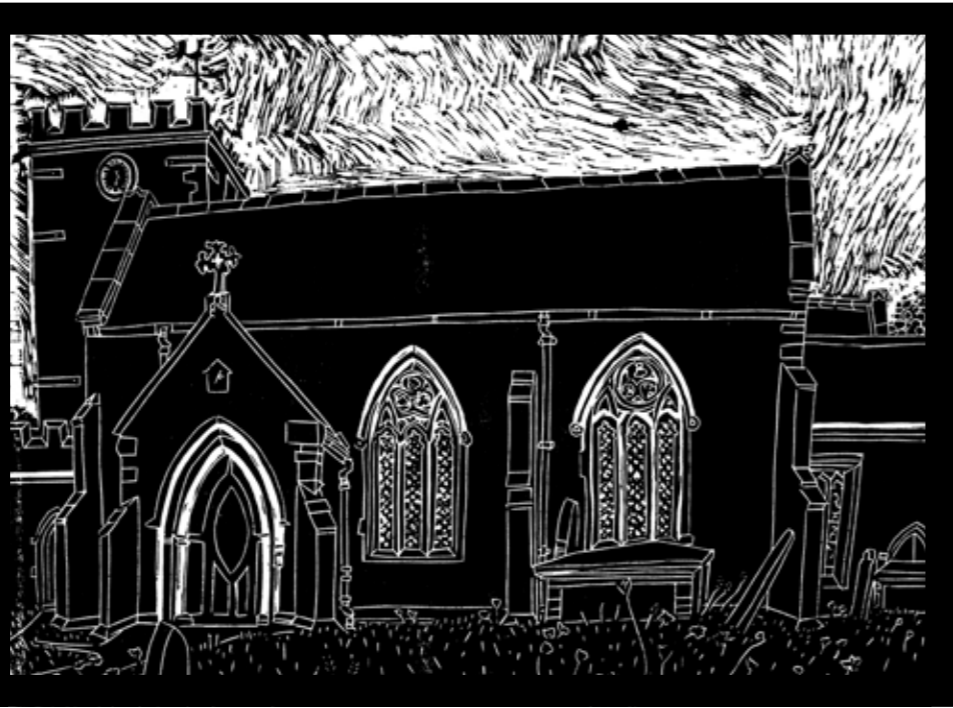

## VJ Day 75 Service

To commemorate the 75th anniversary of VJ Day and the end of WW2 around 60 people gathered around Hemyock War Memorial. Amongst those present were veterans, relatives of the Armed Forces who served in Burma and India, representatives of the Parish Council and the local Royal British Legion Hon. Poppy Appeal Organiser, David Bawler.

The service was conducted by Rev Canon Becky Totterdell. Lt. Col. Tim Courtney OBE, DL, Royal Marines (Retired) spoke of the Battle for Kohima and gave the Epitaph "When You Go Home, Tell Them Of Us And Say, For Your Tomorrow We Gave Out Today". Lt Col Courtenay laid a poppy wreath on behalf of the community.

The Rector read out the names of those men who had lost their lives in WW2 and the Malayan Conflict, gave The Exhortation and a two minute silence was observed.



**Above** Lt Col Courtenay at the salute  
**Right** Poppy wreath and flowers  
**Top Right** Chindits Special Forces Emblem shoulder badge known as the Chindithe (lent by a parishioner whose father had served with them).



## Tea at the Rectory

Villagers from the Upper Culm Valley Mission Community were pleased to accept an open invitation from Rev Canon Becky Totterdell and her husband Michael for tea in Hemyock Rectory garden.

The delightful and much appreciated afternoon was part of a Gift Day organised by the churches of Hemyock with Culm Davy, Clayhidon and Culmstock as between them they faced a loss of almost £20,000 due to the pandemic. The total amount raised was over £7,000 a tremendous result for which all the churches are very grateful.

Held in glorious sunshine the large garden ensured social distancing was easy to adhere to as everyone enjoyed tea and cakes as they caught up with friends some of whom they hadn't seen since lockdown began.

**Top** Rectory garden. (Rev Canon Becky Totterdell on right in striped top). **Above right** Some of the delicious cakes.



## St Mary's Annual Meetings

St Mary's Annual Parochial Church Meeting and Annual Vestry Meeting will both take place on October 25th. The latter elects Churchwardens and you can vote if you are on either the Church Electoral roll or the Parliamentary electoral list. The APCM elects Church council members amongst other things and there the voters have to be on the Church Roll.

The Church Roll was renewed last year and will be revised at the beginning of October. If your name is not on the roll and you'd like to show your support for St Mary's by joining, then please have a word with our Church Roll officer, Diana Cooper, before the end of September.

.....

**Advance notice.** The Meaningful Chocolate company will again be producing their famous Advent Calendars this year, the only ones which come with a 24 page Christmas Story book. St Mary's Charity Shop are planning to take orders shortly. Look out for the posters. And they'll still only cost £3.99 each.

.....

## Help get the Pump out!

It costs £1 to deliver this copy of the Parish Pump to your door, but we don't charge because we want everyone in the parish to be able to keep up with local news and events. Our volunteer distributors help us to keep the costs down, and our advertising revenue helps. But we are also grateful to all the people whose donations help us make up the difference.

Could you help us as well? A £6 donation will cover the cost of your copy of the Pump, for the whole year. If you can't manage that, please just put what you can into the envelope that has come with this edition. You can return the envelope to your local distributor or to Daphne Shepherd at 1 Parklands or Hazel Partridge at 50 Castle Park or to Clare Sibley at Fircroft, High Street.

Thank you for your help.

### St Mary's Charity and Coffee Shop

This is a good news/bad news story. Like many Charity shops around the country we have been having a rather under-occupied summer due to the requirements brought about by Covid 19. With changes in regulations many, but not all, have reopened albeit with differing operational methods. In Wellington for example, 4 of the 6 shops are trading.

So our good news, well we think it's good news, is that we are going to reopen too. The bad news is that there will not be any coffee (or Bacon Butties). As the man said "This is a Charity shop Jim, but not as we have known it!"

The changes we have made are to protect our customers and our volunteer staff. Briefly they are as follows:-

- A one way system with entry via the side door of the Church Room.
- Customers requested to wear face masks and use sanitiser on entry and exit.
- We will take brief contact details in case of need to trace

- Limit to numbers browsing at one time (with some waiting space inside - no queuing on the pavement).
- No "trying on" in shop-new system

There will also be changes to the receipt of donations which will need to be quarantined. The space for this storage is limited so we will limit donations to two bags per customer and may at times have to say "no thankyou", something we have tried not to do in the past..

The staff have been busy making these changes and hope that people will find an altered shop is better than no shop. Our first day with the new style will be Saturday October 3rd, usual time 10 am till 12noon, and then one final change. People have regularly said "It would be easier to remember when you are open if you opened every Tuesday". So until Christmas we will give that a try. **Open every Tuesday 10-12!**

We look forward to welcoming you to the somewhat different Charity Shop.

### THANK YOU...

To everyone who over recent months has donated aid to Christian Response to Eastern Europe. Not only was our car filled but a tarpaulin had to be tied over the trailer to secure the huge number of large bin bags of clothes, bedding, sleeping bags and medical equipment as we drove to the charity depot at Exmouth at the beginning of September. Your support continues to be overwhelming. Hugh, who spoke at St Mary's last year, sends his warmest thanks.

Christmas boxes... since we began supporting this initiative thousands of boxes of all shapes and sizes have been donated from the Upper Culm Valley and surrounding area. These have been distributed throughout Moldova from the youngest to the eldest of folk.

2020 has seen countries facing unprecedented times but in Moldova life has been exceptionally hard. Due to the weather their harvest has been very badly affected whilst people who work abroad to send money home have had to return having a huge impact on their family finances.

We now have personal contact with a family of 4 girls aged 6 -14 and mum abandoned by dad. In the summer the younger two look after the few chicken they have at home whilst the older couple work throughout the very hot months looking after the village cows. They earn £5 working from 7am-8.30pm which is used for family food, school clothing and education -

Many places are closed or working under strict restrictions but FATHER CHRISTMAS IS NOT and he would so appreciate your help. If you feel you could donate a box of new gifts to a child or adult in Moldova please would you deliver to us at 4 South View, Hemyock before the end of October. If you would like it collected please phone 07773579809. We realise time is short but would so appreciate your support.

The information below will give you some ideas if you are not sure what to include.

Thank you

David and Janice

## THANKS



Around thirty people attended one of the first face to face services at St Mary's Parish Church, Hemyock since lockdown restrictions were lifted. The service of Holy Communion was led by the Rev John Stone and the congregation was delighted that the choir, under the direction of Ron white, were able to return and take part in the worship.

It was a particularly joyful occasion as a number of presentations were made by Jenny Doble, one of the Churchwardens. An orchid plant was given to Brenda and Roy Calcraft to celebrate their 60th wedding anniversary. A similar gift was presented to Val and Ron White as they retired from various practical duties which included Val being a member of the Lay Team as well as overseeing the cleaning team for 17 years.

Safeguarding of the Upper Culm Valley Benefice had been the remit of Roger Lambert who received a garden voucher whilst Sue Bennett who had taken the role over and recently retired received an orchid.



## Shoebox Hampers for Moldova

**Please do:**

- Wrap the lid separately so your child can use it as a treasure box for the rest of the year.
- Only include new items.
- Include a Christmas card from you and a photo if you like – they will be treasured by the children.
- Let your imagination run riot! You can include: toys, Lego, games, crafts, school equipment, solar calculator, notebooks, pens, pencils, stationery, shampoo, soap (not bubble bath), toothbrush & paste, flannel, perfume, deodorant, hat, gloves, socks, t-shirt, a dress, watch, tights, balloons, sweets, chocolate ... the list is endless!
- Label your box with Girl or boy and approx age or if for adult - lady/ Gent etc. Then secure it with a band or some ribbon/string



**Just a few ideas if you need any**

For any age you could consider		
Hats	Gloves	Socks / Tights
Underwear	Tea Shirts	Cuddly toy
Tooth Paste	Tooth Brush	Shampoo
Hairbrush	Soap / Shower Gel	Deoderant
Calculator	Cheap watch	Jigsaw puzzles
Chocolates	Sweets	Biscuites
Paints boxes	Crayons	Colouring books
Pencils	Exercise books	Calculator

<b>For Girls</b> Dresses Tights Dolls Friendship bracelets Beads Jewellery Glow Sticks Hair Clips and slides Lip gloss Purse Jewellery <hr/> <b>For older ladies</b> Hand cream Head Scarves Perfume	<b>For Boys</b> Lego bricks Toy cars Wallet Torch Glow Sticks Torch Magnifying glass <hr/> <b>For older boys</b> Pen knife Razor / shaver Shaving cream <hr/> <b>For older gentleman</b> Aftershave Mini tools Coffee
---	--

**Please don't include:**

- Any medicines
- Toy guns, swords etc.
- Anything that could injure a child such as scissors, razors etc.
- Playing cards, which are associated with gambling by many people. Other board games such as dominoes, ludo etc, are fine.
- Bubble bath, because most families don't have a bath.
- Books, other than picture books.
- Glass items or bottles. Liquids, such as shampoo can be sent in a securely sealed plastic bottle.

## A special weekend

The weekend of 29-30 August was a very special one in the life of the Benefice. It marked the end of our months of 'zooming' Sunday morning services, and it heralded our return to worship in the church buildings. We are now trialling a new pattern of services across the benefice, and will review it in February.

So on Friday 28th we held a day of prayer, committing the future to God, and on Saturday we held a Gift Day. Like all local organisations, the church has been hit financially by the lockdown and many regular members have not been able to give their usual weekly contribution to its life and ministry. So the Gift Day was an opportunity for those who wished to, to give what they felt able to. Each of our four churches (Culmstock, Clayhidon, Hemyock and Culm Davy Chapel) were open from 10.00am – 12.00 noon, and each welcomed a number of visitors during that time. In the afternoon members and friends of the Churches gathered in the Rectory garden at Hemyock to enjoy a socially-distanced cup of tea and some wonderful cupcakes. We were careful not to exceed the limit (at the time) of 30 for an outdoor event, and were at our maximum number for most of the time. It was a delightful, warm and sunny afternoon, much enjoyed by everyone.

Thank you very much to all who played a part in that weekend – by praying, by welcoming visitors to the churches, by visiting the churches, by serving tea and cake in the garden, by moving furniture to enable it all to happen, or by giving financially. We were thrilled with the outcome as the weekend raised over £7500 across the benefice to sustain the mission and ministry of the churches, and to contribute to their maintenance. It was a powerful symbol of the goodwill in which our churches are held as we move ahead in our mission to 'love God and love our neighbour', not just on Sundays but through every day of the week.

*Rev'd Becky Totterdell*



## Advent

Christmas is coming, and before that Advent. Advent is the time when we look forward to the amazing fact of God's own son being born on earth to a teenaged mother. Sadly these days many children know Christmas is a birthday but ask them whose birthday and you might get a surprising list of answers.

A survey in 2013 found that 36% of infant school children could not name whose birthday was being celebrated, a further survey found 51% of adults said it did not matter whose birthday it was – they just wanted to celebrate!

The Meaningful Chocolate Company thinks it does matter and to help both children and adults have produced the "Real Advent Calendar" for several years now. It comes with a 24 page story book ideal for adults to read to children or for children to read to adults. And it comes with Fairtrade chocolate (good for the cocoa producers) and it still only costs £3.99.

St Mary's Charity shop have been asked to get some and would be happy to take more orders.

PS. If due to changed Covid regulations the Shop is not open, then please contact us via the Church Council secretary.

### Letter To Our Neighbours

#### House Fire in Castle Park, Hemyock

To all our lovely neighbours in Castle Park,

Following our house fire in the early hours of Saturday 4th July, we would just like to thank all our wonderful neighbours in Castle Park who came to the rescue in so many different ways, in our time of need.

From helping to extinguish the flames, providing comfort and shelter, laundry services, cakes & sweet treats and electricity supply in the following weeks as we temporarily lived in our motorhome on the street outside, we experienced so much love and support, that we will never be able to repay!

This highlights the fantastic community spirit that Mike & I have experienced since moving into the street almost 10 years ago and the friendships that we have built with our fabulous neighbours over the years. Living in Castle Park has been like living amongst family ... and we very much look forward to returning home as soon as possible.

We would both like to send you our heart-felt thanks for all you have done for us!

With best wishes,  
from Mike & Andrea

## Pump Distributors October 2020

Many thanks to our volunteer distributors who ensure that a copy of the Parish Pump reaches all the households in the area.

Churchills Rise	June Lock
The Square/High St	Mike Travers
Parklands	Linda Holway
Logan Way	Kathy Jones
Prowses/Higher Mead	Trish Slater
Redwood Close	Pam Grinham
Prowses/Churchills/Eastmead	Avril Webb
Eastlands	Patsy Preston
South View	David Bawler
Castle Park	Mary Beard
Longmead	Helen Lang
Millhayes Farm	David Corden
Lower Millhayes	Brenda Calcraft
Hollingarth	James Pullen, Patricia Fuller, and Doreen Perrott
Station Road	Gillian and Bob Hawkes
Culmstock Road	Julie Steed
Lower Castle Hill	Ruth Tartaglia
Upper Castle Hill	Belinda Taylor
Ashculm	Lucy Ball
Culmstock	Brian Samuels
Madford	Stuart Husbands
Westown	Neil McLean
Tedburrow	Tim and Jane Courtenay
Lemons Hill	John Churchill
Culm Davy	James and Anthea Edwards
Whitehall/Withy Lane	Sandy Coe
Pencross	Sue Hollow
Symonsburrow	Sarah Taylor
Clayhidon/Rosemary Lane	Judith Ward

You can also pick up a copy of the Pump from Spar, the Post Office and in St Mary's Church.

If you know of someone in the parish who doesn't receive a copy of the Parish Pump, or if you have any other queries about distribution, please contact Mike Travers on 681398.

### Call for Veterans

The Royal British Legion and the Not Forgotten Association are keen to compile a register of living veterans of any service or rank to commemorate this the 80th anniversary of the Battle of Britain.

Would anyone who knows of such a veteran living in our parishes who would agree to being on the register kindly contact Lt Col Tim Courtenay on 01823 680540 or David Bawler on 07773579809 as soon as possible.

Thank You.

Tim

## Hemyock Gardeners Association

Almost six-months since Lockdown but we're still no closer to the "new normal". In August, after much deliberation by the Committee it was decided that it would be unsafe for members to meet up and had to cancel the September, October, November and December meetings in the Parish Hall.

This is very disappointing as so many members look forward to meeting up and listening to our speakers and having a cuppa and chat once a month but everyone's safety is paramount. But there is some good news! All membership subscriptions will be carried over to 2021 so when we are permitted to start up our meetings once more, there will be no subscriptions to pay til 2022.

As always members can keep up with Gardeners on our website and Facebook pages. Photos of your gardens, flowers, produce can always be posted here so members can keep in touch. The acidanthera bulbs grown by members for the – sadly cancelled – Autumn Show have been truly magnificent and several members have put up photos of what would have been marvellous entries to this Class.

Email enquiries@hemyockgardeners.org.uk with any Gardeners' related questions or comments you may have and send your photos here too. Or you can just call 01823 681393 for the latest updates. In the meantime, please stay safe and keep well.

*Susan Scantlebury, Secretary, Hemyock Gardeners' Association.*

## Thank you

'Thank you' from Roy and Brenda Calcraft for all the cards and gifts received on the occasion of their Diamond Wedding Anniversary on September 17th.



**Above** Roy and Brenda Calcraft with Jenny Doble (Warden) presenting them with a gift for the special occasion of their Diamond Wedding Anniversary

## Opening Times



### Hemyock Surgery

Mon – Fri 08:30 – 18:00 – *Please note the dispensary is closed between 13:00-14:00*  
 Sat 08:00 – 11:00

### Churchinford Surgery

Mon, Tue & Thu 08:30 – 12:30 and 15:00 – 18:00  
 Wed & Fri 08:30 – 12:30 – closed in the afternoon on these days  
 Weekends Closed

### Dunkeswell Surgery

Mon & Wed 08:30 – 12:30 and 15:00 – 18:00  
 Tue, Thu & Fri 08:30 – 12:30 – closed in the afternoon on these days  
 Weekends Closed

If you require urgent medical assistance or advice outside of normal surgery hours **please call 111. In a genuine emergency you should call 999.** Chest pains and / or shortness of breath constitute an emergency.



### Blackdown Support Group – News

#### Transport Service

We continue to accept transport bookings for GP, hospital, dental, optician and other appointments.

We can also offer fortnightly shopping trips if required but please note volunteer driver availability may be more limited than usual and medical appointments will be prioritised.

A Perspex screen has been fitted to our disabled access vehicle as an additional protective measure. This vehicle can be used with or without a wheelchair and hired either as self-drive by a family member or friend or with a BSG Volunteer driver.

**CALL THE OFFICE ON 01823 681 036 TO MAKE A BOOKING – TRY TO GIVE US AS MUCH NOTICE AS YOU CAN.**

**PLEASE LEAVE A MESSAGE ON THE ANSWERPHONE IF WE CANNOT TAKE YOUR CALL. MESSAGES ARE CHECKED DAILY AND WE WILL CALL YOU BACK AS SOON AS POSSIBLE.**



#### NEW VOLUNTEERS NEEDED

Many of our volunteer drivers, whose faces will be familiar to those who have used our transport service regularly in the past, are unable to assist us at present. If you have a little spare time and would like to support your community in a flexible and fulfilling way please get in touch. Full guidance and PPE will be provided.

If you are unable to help as a volunteer driver but would like to support us in another capacity we would love to hear from you. We continue to offer telephone befriending support to people who live alone – this service will be increasingly important as the colder weather returns and it may be harder for some people to get out of the house.

Elizabeth McNabb at [bsg.elizabeth@nhs.net](mailto:bsg.elizabeth@nhs.net) or call 01823 681 036. We would love to hear from you.



**A**s I'm sure you are aware, The Blackdown Healthy Living & Activity Centre has been closed since late March, due to Covid-19.

We re-opened for Yoga with Julia on Monday evenings in September and we hope that Pilates, Keep Fit and Tai Chi classes will run later in the year. We continue to liaise with Mid Devon County Council and Devon Communities Together as to when we can safely re-open our 'Care for the Elderly' services.

Ruth Bell (Massage), Sue Moore (Chiropractor) and Martha Price (Osteopath) are seeing patients again so please contact them directly if you would like to book appointments. We will update our website, [www.bhllac.org.uk](http://www.bhllac.org.uk) and Facebook page once we are able to re-open.

*Peta Dayus-Jones  
Centre Manager*

#### The Blackdown Healthy Living & Activity Centre – AGM

The Annual General Meeting of the Blackdown Healthy Living & Activity Centre will take place on Thursday 19<sup>th</sup> November 2020

at 7pm. The meeting will be held virtually on Zoom. If you would like to attend our virtual AGM please book your place by emailing [centre@bhllac.org.uk](mailto:centre@bhllac.org.uk) by Monday 7<sup>th</sup> September 2020 and you will be sent a meeting ID and passcode.

All are welcome, but to vote and have a say in the running of the BHLAC it is necessary to be a Friend of the Blackdown Healthy Living & Activity Centre. Becoming a Friend is very simple so please consider becoming a Friend to show your support and entitle you to vote at our AGM.

Forms are available at the Centre or you can request a form by emailing [centre@bhllac.org.uk](mailto:centre@bhllac.org.uk)

Business to be conducted at the AGM will include presentation of the annual accounts, the Chairman's report and election of trustees. Please call 01823 680687 or email [centre@bhllac.org.uk](mailto:centre@bhllac.org.uk) if you have any questions.

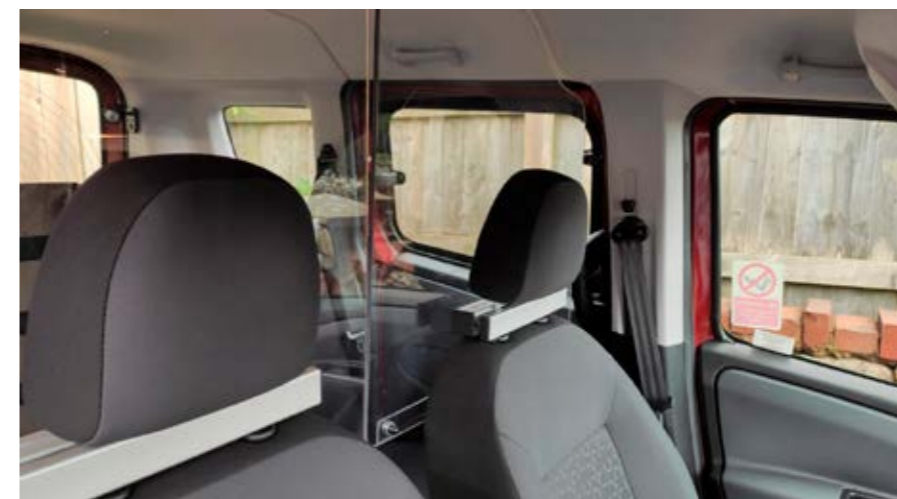

**Left and Above** The perspex screens fitted to the interior of the disabled access vehicle.



### 'Shedders' come to Hemyock

An exciting new venture will soon be coming to Hemyock—the Blackdown Men's Shed is on its way! For those who may have heard the term but not necessarily know much about the initiative, it is an international project designed for men with the aim of encouraging and improving practical skills while also promoting social interaction.

There are now nearly 600 Sheds running in UK and we are delighted to announce that the Blackdown Men's Shed will be opening in a bespoke room within The Garages (Millhayes in Hemyock) later in the year.

In essence, Men's Sheds are similar to home garden sheds - they are places to pursue practical interests, to practise skills and enjoy making and mending. The difference is that, while home garden sheds and their activities are often solitary in nature, Men's Sheds are entirely the opposite: they're all about social connections, building friendships and support networks and sharing skills and knowledge.

The negative impact of loneliness and isolation on a person's health and wellbeing has become ever more apparent in recent months, and research and studies over the years have shown the same. It is now understood that men typically find it more difficult to build social connections than women, but unlike women of a similar age, fewer older men have networks of friends and they also rarely share personal concerns about health and personal worries. It is not the case for all men, but for some, when retirement comes, it can feel like personal identity and purpose is lost.

Men's Sheds can change all of that. They are about meeting like-minded people and having someone to share your worries with. They are about having fun, sharing skills and knowledge with like-minded people and gaining a renewed sense of purpose and belonging. While Sheds often attract older men, they are open to men and women of all ages.

Sheds are for whatever the members (or 'Shedders' as they are often called!) want. Activities vary greatly from Shed to Shed, but you can often find woodworking, metalworking, repairing and restoring, electronics, model buildings or even car building in a typical Shed. Many Sheds get involved in community projects too – restoring village features, helping maintain parks and green spaces, and building things for



schools, libraries and individuals in need. While our Shed will initially be tailored to woodwork, we look forward to seeing where our Shedders take us in the future.

Shedders usually enjoy a 'shoulder to shoulder' camaraderie. That sentiment still remains but we will need to be socially distanced for the time being and, as such, session capacities will be restricted. To express an interest in, or to join, Blackdown Men's Sheds, please contact Jon Dagger at menssheds@bhlac.org.uk. While we have managed to source a number of tools, we would be very keen to hear from anyone who would be willing to donate to this initiative.

*Peta Dayus-Jones,  
Blackdown Healthy Living & Activity Centre*



**STAGS**

**TO LET**

**Commercial Unit/Secure Storage Space**

at

**Highlands Farm, Hemyock, Cullompton, Devon**

**EX15 3RU**

**500m<sup>2</sup>**

Available as a Whole or in Part

Tel: 01823 653424



### 2020 Poppy Appeal

Due to the pandemic the door to door appeal on behalf of the Royal British Legion will not take place this year. Instead a village collection point will be set up near the Post Office on the following days and manned from 9am - 4pm

- SATURDAY 24th OCTOBER**
- WEDNESDAY 28th OCTOBER**
- TUESDAY 3rd NOVEMBER**
- SATURDAY 7th NOVEMBER**

Poppies will also be available from local shops and the Catherine Wheel.

A service will be held at the Parish Church on Sunday 8th November at 10.15am followed by the laying of wreaths at the War Memorial.

Wednesday 11th November - a short Commemoration will be held at the War Memorial at 10.45am

Whilst church numbers are restricted due to social distancing and masks **MUST** be worn in church everyone is welcome at the War Memorial on both occasions.

At Clayhidon poppies will be available at the Half Moon during opening hours.

David Bawler  
RBL Hon Poppy Appeal Organiser  
Tel: 07773579809



### Poets Corner

#### The Stem of Life

Open to the summer sun,  
Dew fresh purse of nectar sweet,  
Bows to weight of flirting bees  
Who, fickle cast their favours wide;  
Brief passing touch of joy,  
Then flowers fade  
Span of life half o'er and,  
Petals dry and autumn brown and drop,  
Among the mouldering leaves of fall;  
Dry seed scatters hither, lost,  
To winter dark,  
Lies waiting for the coming spring  
And Life to come,  
Then, reaching upward to the light,  
Grows up towards another spring and,  
Summer sun.

*David Palmer*

### The Lights Parade 2020

It will come as no surprise, but we are sorry to have to announce that there will be no Lights Parade this year. This is due to the cancellation of the Spring Dance and resulting lack of funds as well as the ongoing uncertainty of the Covid-19 situation. We will, of course, light up the village as usual from early December.

The Lights Parade will be back next year funded by the Spring Dance, with 'Holy Moly and the Crackers' and support, on 1st May, 2021. Tickets on sale in early Spring!

Thanks to those that have kindly supported us this year, including donations from the Blackdown Practice, the Hemyock Table Top Sale and Emily Pring's plant sales.

Take care.

The Lights Brigade committee



# What's On (Or What's Off!) October 2020 / November 2020

**COVID 19: All events are subject to cancellation** or postponement due to government restrictions. Where possible, some activities and events may now be online. Please check directly with the organisers. **Follow government guidance to help save lives and help the NHS.**

### Notable dates for October

- OCT 09** Bereavement Counselling, 10.30am – 12md, FL
- Oct 14** " " 2.30pm – 4pm, FL
- Oct. 25** British Summer Time ends
- Oct 26 – 30** Local Schools Half Term

### Notable dates for November

- NOV 08** Remembrance Sunday
- Nov 11** Bereavement Counselling, 2.30pm - 4pm, FL
- Nov 13** " " 10.30am – 12md, FL

Forthcoming Events		
Dec	25	Christmas Day
Dec	26	Boxing Day
Dec	28	BANK HOLIDAY (Boxing Day is on a Saturday)
Jan	08	Blood Donors, Parish Hall

If you wish to give people an early notice of your events by getting it in the "Forthcoming Events, please notify Sue Lambert, 680664 or at her **new email address** - [sueliz.lambert30@gmail.com](mailto:sueliz.lambert30@gmail.com) by the "Parish Pump" deadline date. (This may stop too many clashes of dates!)

**Parish Pump Deadline**  
**December – January issue: 14th November**  
 Editor: James Winrow  
[pump@lickham.co.uk](mailto:pump@lickham.co.uk)  
 07763 855414  
 Commercial advertising:  
[pump-adverts@lickham.co.uk](mailto:pump-adverts@lickham.co.uk)  
 Distribution: Mike Travers 01823 681398.

**Apology**  
 It was incorrectly reported in the last issue that Hemyock Castle was open for the Heritage day. We apologise for any confusion and concern caused by this error.



## Lockdown Life Cartoons

Cartoons by Dave Walker,  
[CartoonChurch.com](http://CartoonChurch.com)

### THE CHAIN OF COMMAND WITHIN A CHURCH

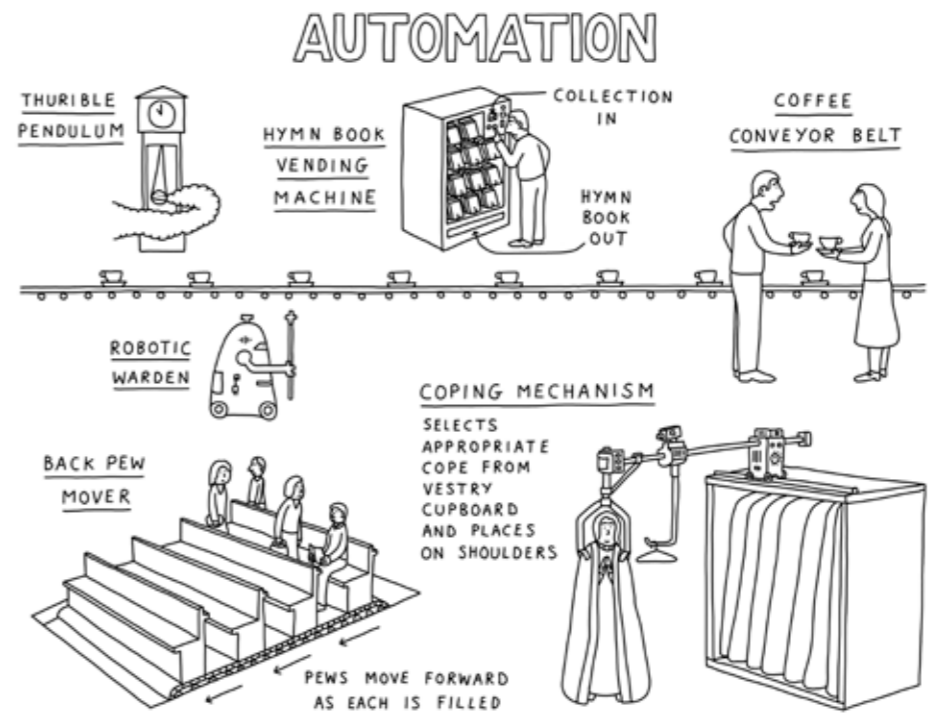
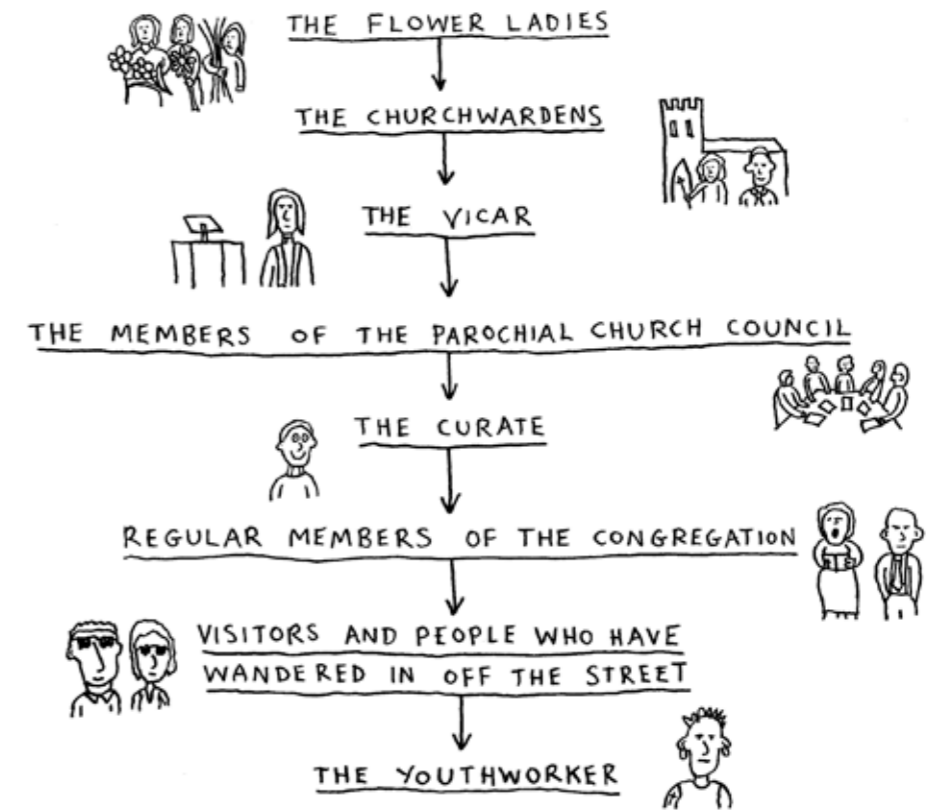

## Around Hemyock

**O**h dear, just as things took a turn towards normality we are faced with different restrictions. We are lucky that we have not seen a large number of Covid cases in our area but I am sure there are many like us who have family or friends where case numbers are high and restrictions have far more impact. In Hemyock, and our surrounding villages, where so many events have been cancelled it is good to see some sporting activities are taking place.

Children, and no doubt parents, are glad that schools have now reopened albeit very differently to how it was before the pandemic. Our daughter is a teacher in a secondary school and we have grandchildren nearing the end of primary education so we are only too aware of many of the problems school have seen and are continuing to face. Staff throughout the education system have worked incredibly hard to ensure they and the young people they work with are safe. **Thank you to all at our local school.**

**Warm thanks also to our local medical and support teams.** New methods were quickly put into place for appointments, prescriptions and the 101 things our wonderful medics and their colleagues deal with. Phone consultations, face to face appointments, home visits, repeat prescription arrangements - all needed a great deal of urgent planning to help keep us all safe and our whole area are grateful for all they have done.

Thanks to the support of people observing social distancing our shops and pub have been able to offer continuing good service throughout the recent past months. Whilst our churches have continued to provide services and support unique to them.

## Ivy – never underestimate its goodness!

**A**utumn is in full swing but there is at least one plant that is in full bloom. Not spectacular to look at, yet ivy is an important source of nectar for bees, moths, flies and wasps, and while they are not most people's favourite insects, they all play a vital part in Nature's jigsaw.

Ivy produces flowers from September to November. Spherical clusters of greeny-yellow blobs, which on closer inspection have endearing little horns with knobs on! The resulting fruits are dark berries with ridged sections, resembling tiny black footballs each containing five seeds. Poisonous for us, but birds love them.

Ivy is one of the few native climbing plants that can reach a substantial size. Contrary to popular belief, it is not a parasite. Its stems have lots of fibrous, adhesive-covered, roots which cling to buildings, brickwork, trees, telegraph poles, in fact just about anything to help it gain some height. However, when it comes to nourishment, that comes via the roots in the ground. [There's not much nutritional value

At his time of year plans would normally be well advanced for many forthcoming events - Valley Arts stage production, Remembrance parade, Hemyock Singers concert and meal, Christingle and Carol services, Christmas Fair and numerous other local activities but it would now seem all this is unlikely to take place. **One can only hope that Father Christmas and his elves remain well and have no restrictions placed on them or their reindeer!**

Our congratulations to **Roy and Brenda Calcraft** celebrating 60 years of marriage.

We send get well wishes to all those known to us who are unwell, especially Barbara recovering from heart surgery and Janet of Castle Hill. Also those who are recovering from an accident whilst our prayers and condolences are sent to those who have recently had a loved pass away including the family of **Barbara Povah**.

**“...Staff throughout the education system have worked incredibly hard to ensure they and the young people they work with are safe.”**

If you have relocated here over recent months you will know you are in a beautiful area of Devon. If you have seen the previous issue of the Parish Pump you may have noticed the long list of clubs and associations listed on the back cover. Hemyock is a parish full of activities and you will be warmly welcomed at any you choice to join... we are all just waiting for life to return to normal so we can get to know you!

With so little happening due to Covid19 we would be delighted to have any news you would like to share. Please send to the address below.

Stay safe everyone.

Janice – [jbawler1947@hotmail.co.uk](mailto:jbawler1947@hotmail.co.uk).

in a brick.] Although ivy does not normally damage sound buildings or walls, and is rarely a threat to healthy trees, its weight can cause problems.

What a useful plant it can be! Providing shelter, hibernation and nesting sites for birds and insects, its glossy green leaves are happily munched by sheep, goats and deer. These leaves, so familiar, are different shapes according to whether they are on flowering or growing branches. The flowers are surrounded by heart- or spear-shaped leaves, while the rest of the plant has the three- or five-pointed ones we all recognise.

Many legends involve ivy. But has anyone discovered why although mentioned in the first line of the carol 'The Holly and the Ivy', it is absent from the rest of the verses?

## Derbyshire's Estate Agents

**D**erbyshire's Estate Agents are now open having recently taken over from Worth Property Services and can be found situated at the Halifax House in Hemyock (opposite the Hemyock Parish Hall).

As luck would have it the opening was just after lockdown began however in the few months that have followed they have been rushed off their feet with people wanting to rent and buy in the Blackdown Hills area which has reinforced to them the reason they should move into the area with an office and become part of the local community.

Derbyshire's specialize in village and rural properties (sales and lettings) and offer bespoke marketing solutions for individual properties. They are in urgent need of more properties due to a high demand of enquiries so if you are looking to sell or rent a property do give them a call for a free valuation.

They will ensure when visiting your property that social distancing guidelines are maintained and that masks and gloves are worn to ensure you are kept safe.

For more details about properties for rent or sale please visit their website [www.derbyshires.net](http://www.derbyshires.net) or pop into their Hemyock office for a friendly chat or make contact with them by phone on 01823 681300 or by email at [hemyock@derbyshires.net](mailto:hemyock@derbyshires.net).



## The Violet Chapman Trust

The Violet Chapman Charity (Charity registration number 299996) was established in 1986 after Mrs Violet Chapman, who was a patient of the Blackdown Practice, gave a substantial gift to the doctors, which was intended to provide patients with services and help that were not available under the NHS.

The original Trustees were Dr Jonathan Meads, Mrs Chapman and Sir Christopher who, at that time, was senior partner with Ashfords Solicitors and one time president of the Law Society. The Trustees were, at this time, all volunteers not drawing any salary or expenses, and this remains the case to date.

The Trust has discretion to give grants for medical equipment and treatments as well as giving financial assistance to patients of the Blackdown Practice for numerous purposes.

All grants are given for the physical and mental wellbeing of the patients, and many will gain support by the help the Trust gives in supplying counselling where the NHS is unable to supply.

There are many examples that we could give of the patients we have helped recently and would cite one that required

their bathroom to be modernised to enable them to continue to live at home; another patient who needed a chair that would help them in getting in and out without assistance. Another example is a patient who had severe back pain and a grant was given for them to have remedial massage.

If you feel the Trust can help you we would suggest you talk to your GP or any person who gives you support and submit an Application form which can be found online or pick one up from any of the Blackdown Practice surgeries. The Trustees are only too happy to consider any applications. Alternatively for more details please contact the secretary, Mrs Judy Barton on 01823 680975 or [j.h.barton@hotmail.co.uk](mailto:j.h.barton@hotmail.co.uk).

The Trustees are proud of the speed with which they are able to help patients and in many cases are able to provide financial assistance within two weeks.

The current Trustees are Mrs Shirley Wyatt (Chairman), Mr Stephen Walker (Legal representative - Ashfords), Mrs Judy Barton (Secretary), Mrs Penny Browning, Dr Susan Brocklesby, Mrs Doreen Pike and Mr Tom Baker.

**COULD WE HELP YOU?**

## Longmead

**The Pavilion** is an ideal venue for smaller events needing outdoor space, birthday parties, christenings, family gatherings and of course meetings, the building is licensed to sell alcohol and has a large screen tv and there are basic kitchen facilities for your use. **The MUGA** (Multi Use Games Area) is also available for hire, why not combine the two and have a football party? Its ideal for 5 aside football, netball, hockey, we also have basketball hoops for use, is anyone interested in starting up a new club?

### Hire charges

Pavilion - £7.50 per hour  
MUGA - £15.00 per hour

If you wish to book any of these facilities or would like some more information please contact Karen 01823 681034 or email [kazapinder@hotmail.com](mailto:kazapinder@hotmail.com).

## Wellington Monument repair update

Overall, the repair works are progressing well and due to be completed as planned in Spring 2021. Work slowed down temporarily during lockdown but thanks to a clear plan from our contractors, Sally Strachey Historic Conservation, activity was able to continue in some form throughout.

Most of the construction team are currently working on the upper middle part of the monument. The work here involves tooling stone, grouting and installing anchor ties to aid stability.

The next big milestone is scheduled for October when the capstone or very top triangular head of the monument will be craned back into place.

### Things to do

We had originally planned to run scaffold platform tours for visitors to enjoy the views and see some of the damage that will be repaired. Social distancing rules prevent us from doing this for the time-being. Whilst these plans are on hold, we've created other ways for people to find out what's happening.

### Spotter sheet

A new Wellington Monument spotter sheet has been created focusing on nature challenges and unusual items connected to the repair programme. The sheet will be available for visitors to access on a mobile device from the National Trust Wellington Monument webpage and is also on the National Trust app: <https://www.nationaltrust.org.uk/wellington-monument>

This family-focused offer will be supported by a welcome blackboard in the car park suggesting further self-led family activities around a different theme each week.

### Letter to Clubs from the Parish Pump

I am responsible for the "What's On" and "Forthcoming Events" in the Parish Pump.

When I put in what's happening into the "What's On" I go by the regular times that you've told me. There are occasions when I guess you may not be meeting at the usual time (Bank holidays, Christmas, New Year etc), but **I don't know what your plans are**, so I have to put the usual times in. This means, of course, that sometimes things are NOT correct.

I would be grateful if you could give me any information that will affect the details in the Parish Pump by the deadline. It does mean looking 2 months ahead which is not always easy! I hope this will give the village a more accurate and up-to-date Parish Pump magazine.

Sue Lambert, tel. 01823 680664,  
[sueliz.lambert30@gmail.com](mailto:sueliz.lambert30@gmail.com).

Editor, James Winrow, [pump@lickam.co.uk](mailto:pump@lickam.co.uk)

Note from the Editor: If you have an event you want listed in the "What's On" calendar section of the magazine, please also notify Sue using the details above. Don't assume it will be done automatically if you submit an advert, copy or poster to me.

### Wellington Monument audio guide

A short audio track has been created to accompany a visitor on their walk from the car park to the monument. The guide talks the visitor through the monument's ups and downs, details the repair programme currently taking place and explains more about the fundraising appeal. This can be accessed on a mobile device or on a computer at home. The audio will be available on the National Trust website as well as a podcast on Spotify, Apple Podcasts and Google Podcasts – a first for the National Trust.

### Donate and grab your unique piece of history

Pieces of Wellington Monument stone are now available to own in return for a donation to our ongoing fundraising appeal. An information point located on site on Wednesdays and Sundays, 10.00am till 1.00pm (weather permitting) will provide an opportunity to choose your own stone with a certificate of authenticity to help raise the outstanding £500,000 needed to protect the monument.

### For more details of our appeal please visit

[www.nationaltrust.org.uk/wellington-monument-appeal](http://www.nationaltrust.org.uk/wellington-monument-appeal)

To keep up to date with developments you can follow us on by following us on facebook at **SomersetOutdoorNT** and twitter **SomersetOutdoorNT**

## Hemyock History Group

We are involving the Exeter Heritage Centre and the National Archives to research the following cases which have been raised by the receipt of emails to the Blackdown Archives web site and hope once the information has been fully documented that they will be presented at one of our meetings. We are discussing when and where to arrange the meetings and are following guidance as to a suitable venue. If any of our members have any suggestions then please send an email to [info@blackdownarchives.org.uk](mailto:info@blackdownarchives.org.uk).

If any member or resident of Hemyock would like to become involved in the research then please contact us.

1. Thomas Clapham the elder and Thomas Clapham the younger.

Thomas Clapham vicar of Hemyock between 1549 and 1587 was also clerk to the Earl of Southampton, Thomas Wriothesley who bought the Manor of Awliscombe and Manor of Boadhembury and Grange for £1,200 as a result of the dissolution of Dunkeswell Abbey.

An article in Devon and Cornwall Notes and Queries (vol. 32, p. 39) states that the Rev. Thomas Clapham was involved in a court case regarding non payment of rent on "the parsonage in Hemyock." We have seen this record on Calendar of State Papers.

We now believe there was a murder committed, prior to 1583 and any trial would have taken place at the Assizes, the records for which are held at The National Archives (reference: ASSI).

At this time, Dunkeswell Abbey, 5 miles from Hemyock, had been dissolved with the 9 Monks being dispersed around the area with various sums provided as pensions. The Abbey prior to this had been financially supporting the local communities by providing vicars and their stipends.

2. Michael Bowerman, whose family once lived at Whitehall Manor has researched the family over many centuries and is planning on talking to our group when our members feel confident to attend a meeting in Hemyock. We've been busy in anticipation of meeting up again and have been researching quite a bit. Michael will be visiting Brooke Manor, seat of the Bowerman's and staying there for a few days early October. The main purpose will be to discover what was the reason for John Bowerman to move to Hemyock to marry Lady Kirkham of Taunton. We are also quite interested in the fact that Hugh Bowerman, son of James Bowerman and Isabel Carvanell became the principal officer for the English Merchants in Spain and was stationed in Malaga where he is buried. All this around the time of the Armada. But more will be revealed during Michael's talk.

Michael also believes that Osborne House was owned by the Bowermans prior to the ownership passing to Queen Victoria.

Both murders in Hemyock seem to be related to the religious wars of the 16th and 17th Centuries. We hope to have information available for talks later this year. We also have interested members researching subjects and planning to talk to our group later this year or early next year. We welcome any member looking to talk to us on suitable subjects.

A record at the National Archives is as follows:

Short title of court case between Clapham v Helaye. Plaintiffs: Thomas Clapham of Hemyock, Devon, clerk...

C 2/Eliz/C20/48

Short title: Clapham v Helaye.

Plaintiffs: Thomas Clapham of Hemyock, Devon, clerk chaplain to Henry Wriothesley, third earl of Southampton].

Defendants: Christopher Helaye of Creech, Dorset.

Subject: Non payment of sum agreed for lease of parsonage of Hemyock; suit against plaintiff over clauses in lease.

Document type: [pleadings]

1586

The National Archives, Kew  
Public Record(s)

Mike Cooper



**Do you buy from Suttons Seeds?**  
**\*NEW CODE**  
Get **35% off** seeds and 10% off other items from Sutton Seeds while also raising money for Hemyock Scout Group.

Just use the offer code **GC1001E** to get the discount and Hemyock Scout Group will receive a donation for every purchase made.

Visit [www.suttons.co.uk](http://www.suttons.co.uk) to have a look at the range of items available!

To find out more information about Hemyock Scout Group visit their website [hemyock.scoutsites.org.uk](http://hemyock.scoutsites.org.uk)



### Funding for community projects



Do you have a project which will have an environmental, social or economic benefit?

The Blackdown Hills AONB's Sustainable Development Fund (SDF) gives grants of up to £3000 to encourage individuals, community groups, schools and businesses to try to achieve a more sustainable way of living in the Blackdown Hills.

Find out if your project qualifies and apply for a Sustainable Development Fund grant:

Tel: 01823 680681  
Email: [blackdownhills@devon.gov.uk](mailto:blackdownhills@devon.gov.uk)

### LEAP News – Summer 2020

**W**ork has continued at the Longmead environmental area thanks to the generous donations of time and materials. We held a Himalayan balsam removal weekend on 1st-2nd August when we were fortunate to have a few really enthusiastic folk to pull up the balsam and prevent its spread.

The long grass had also been topped, so a number raked it up and made a hay-rick. At the same time, Keith and Anabelle Barr constructed three new raised beds from the timber donated and cut to size by Andy Brooke. Aspects of the day, were filmed by Jenny Parsons for the Hemyock film archive.

Over the last few weeks, the raised beds have been filled with soil provided by Sean Richie from the revamping of the children's playground. There has also been some reclaimed timber from the old climbing wall, which will be used in future projects. One of the raised beds has been planted with blackcurrant and gooseberry bushes – soft fruits to follow.

Greendays adults will be back for one Friday a month from October, and Nick and I will be available to support them along with the adult volunteers.

I will be meeting with James Maben, who supported us in the grant bid, next week to set up the program for spending the grant and fulfilling the criteria.

A picnic bench, donated by HPC, has been sited near to the river. It is a great place to sit and enjoy a cuppa and a biscuit and once the vegetation dies back this Autumn, there is a lovely view of the stream.

Don't forget that there are herbs and chard to be foraged in the beds. You are most welcome to take what you need.

We had intended to hold a seed and plant swap but with the new Covid19 restrictions, we have decided to postpone it until February/ March of 2021. Hopefully by then, we will be the other side of the precautions that keep us all apart. Please keep storing seed and propagating plant cuttings for that event. Won't the Spring be lovely!

As ever, do get in contact (call 681081 or email [trish\\_llysawel@yahoo.co.uk](mailto:trish_llysawel@yahoo.co.uk)), if you want to be part of the Longmead environmental group or have any suggestions or observations. Take care!

Trish Slater  
September 2020



### 1st Hemyock Scout Group

**H**ello there and so it goes on. In scouting circles quite a lot has been going on in the background to try to get back to some "proper" scouting. Scouting HQ has been working on various levels to restart us safely and as of the beginning of last week we were going to have a major on line meeting to discuss the way forward. However since then we are now faced with the "Rule of Six" which the government brought in from Monday 14th September. (In fact the day that I wrote this report). So we are back to square one. We will not be defeated, we will Be Prepared and we will continue as scouts doing our best.

So, I am afraid that I will have to delve back into history again in order to give you a short report from our Group. Firstly our famous Annual Sale. Alas another victim of our present circumstances. No sale this year, It will be the first time that we have missed since starting in 1962. I remember it well, Rikki was there! We raised the magnificent sum of just over £30. In those days that was enough to purchase a six man patrol tent. We could not have been more pleased. As years went by our sale became more and more famous, with crowds queuing down Culmbridge Road waiting for the doors to open. We are extremely grateful to the thousands who have supported us over the years and without the funds raised we would not be as well off with the equipment that is essential to give our young people an excellent level of scouting. Again thanks to all and look forward to seeing you next year. First Saturday in October—see you there!

***"My favourite was forestiere sauce which included bacon, mushrooms, cream and dare I say it, white wine. Perhaps we are not allowed to include the wine these days, I will consult with our leaders!"***

What next? Scout cooking. This is a major part of scouting in Hemyock, with not a programme being produced without cooking being involved, be it Great Falls, Sand Pits, Gaddon Woods or anywhere that local kindly souls allow us to use their land.

Thanks to them. We have been around for sixty years and back in the early days sausages and beans were well to fore in our cooking skills. Sausages did taste quite nice burnt on the outside but not so well cooked on the inside! However I believe that we have all survived. We did progress over the years and this was helped by a London chef (he worked at Fredricks in Campden Place, an excellent eating house). We were fortunate that he moved with his family to Culmstock and his son joined our group. We soon found out that dad was a chef. So Tony was persuaded to join us at our weekly meetings and cooking was on the menu. This started in Uffculme School Hall where we sometimes met and the first dish was chicken biriani which the scouts cooked over small gaz stoves and we all thoroughly enjoyed the results. Tony stuck with us and came outdoors and extended his skills by cooking over open wood fires. We had moved on. Steaks, pork chops, various types of fish, vegetarian and more. We also learnt how to make a variety of scrumptious sauces. My favourite was forestiere sauce which included bacon, mushrooms, cream and dare I say it white wine.

Perhaps we are not allowed to include the wine these days, I will consult with our leaders! Times change.

Have just looked through my scouting for boys on camping. Back in the day we had biscuit tin ovens (sixty years ago biscuit tins were actually made of tin - I'm sure you remember), reflector fires, trapper fires, roast bowls made of lots of mud to make an oven and crane cooking to mention but a few.

Enough from Rikki, as you can see we had fun a long time ago as our current group of scouts do and as all the scouts in between have done. Long may it continue and I know that it will after our present problems become a distant memory.

So, Be Prepared, Stay Safe and you may have to put up with some more history next time!

Old Rikki

### New Novel for Hemyock Based Author

**E**lfrida Next Door by Susan Barrett has recently been published and is available on Amazon both as an eBook and as a paperback.

Anyone who is interested to discover more can find the book on Amazon: <https://www.amazon.co.uk/Elfrida-Next-Door-Susan-Barrett/dp/1999648056/>

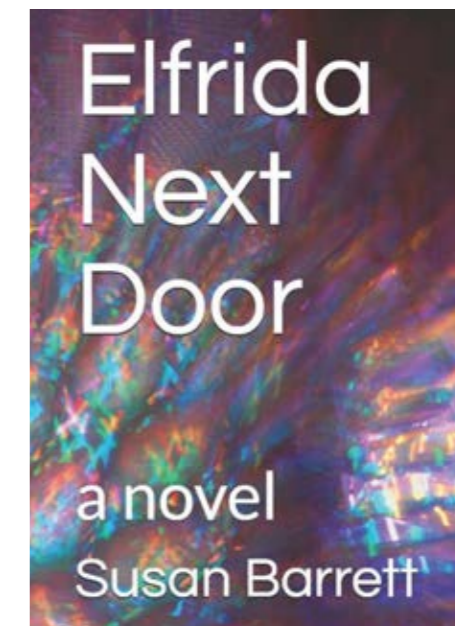

### Dear Residents

**N**ot much to report this time, Aug is always a quite month, and haven't really got going yet, but we will get busy from now on, because we will be heading towards budget preparation time, what with covid, things will be very different. All our meetings are virtual meetings. If you have any issues, by all means let me know.

I have met with Phil Morgan, County Highways Officer, over the doing what matters, he has now put together a plan of the three most needed roads for attention in each Parish, this now will be considered by the asset management team, because there will not be enough funds available to complete all the schemes of every Parish in this next year.

There is a Government white paper due out later this month concerning changes to the structure of local government and a possible move to unitary council system. County Council Network have produced a document analysing the possible savings in expenditure on a yearly basis of each County being allowed to become a unitary council on existing boundaries. There is a document been produced on this, it is 70 pages long, but I have not read it yet.

The document talks about unitaries being between 300 to 600+ electorate, this will have to be taken into consideration if change is made in Devon because Plymouth and Torbay are relatively small unitaries. One of the criteria, is that all unitaries must have whole district areas, such as the whole of Mid Devon being part of a unitary. It would look like Devon would have two unitaries at least because of the numbers. I think the white paper is heavy on creating unitary councils as opposed to two tier councils. A number of Counties have already been having early conversations with Government with a request to change to unitaries. Most Counties have had counter proposals being put forward by Districts, grouping themselves into smaller units by claiming to be reflecting to be better needs of the residents. We will have to watch this space. I think this is what has brought about GESP, which has been rejected by East Devon and now Mid Devon, so that is dead, but, I think a different version will come back for consultation because of the 'Need to co-operate with other local Councils, this something that is required within the planning process.

As the schools are now back from their lockdown and holidays, most schools in Devon, over 90% have returned for schooling. I haven't heard of any issues within the Culm Valley area, so assume there are no immediate issues. It must be very difficult for schools to work within the law, just hope they will be able to keep everyone safe.

"Nationally, you'll be aware that the number of confirmed covid cases in some areas are rising, which has led to tighter restrictions being introduced. Although Devon's rates have been comparatively low so far, we cannot be complacent.

Just like the rest of the country, we have seen a significant rise in the number of confirmed cases in September. Not all new cases are now linked to returning international travellers, which was the pattern we had seen recently. We must remember that coronavirus is still a very real threat to us all, especially to our older and vulnerable residents."

Coronavirus is still a very real threat to us all. You may have heard England's Deputy Chief Medical Officer, Professor Jonathan Van Tam, describing the latest "big change" in coronavirus infections across the UK as a "great concern" and that he believes we are in for a "bumpy ride over the next few months" if people did not adhere more stringently to the social distancing rules.

New rules from Monday (14 September). People will not be able to meet socially with others from other households in groups of more than six people.

That applies indoors and outdoors, including in people's own homes.

Rules around social distancing and the use of face coverings still apply too.

We are committed to providing the best quality and support for dementia care and are collaborating with care home providers to support sharing of best practice and to review briefings from the Alzheimer's Society and Dementia UK who we already work closely with.

There will be penalties for breaching the new rules. The police will have powers to enforce, and fines of £100 could be issued. Fines will keep doubling for further breaches, to a maximum of £3,200.

In March the Government announced a new Pothole Fund to be awarded each year to highway authorities from 20/21 until 24/25 with Devon's share of this funding for 20/21 being £28.869m inclusive of the last year of the Pothole Action Fund at £1.92m. This increased capital funding adds an additional £26.949m to the capital programme approved in May this year, the largest capital programme ever at £81.843m.

Any problems/concerns, you know where I am.

*Ray Radford, Devon County Councillor, Willand & Uffculme Division  
Email: ray.radford@devon.gov.uk*



### Hemyock Bus Timetables



#### Taunton - Hemyock - Honiton - Seaton

Stagecoach South West

Timetable valid from 25/07/2016 until further notice.

Direction of stops: where shown (eg: W-bound) this is the compass direction towards which the bus is pointing when it stops

Mondays to Fridays											Saturdays									
Taunton, Castle Way (S-bound)	0850	1115	1415	1715							0850	1115	1415	1715						
Hockholler, Heatherton Grange Inn (SW-bound)	0900	1125	1425	1726							0900	1125	1425	1726						
Wellington, Post Office (SW-bound)	0911	1136	1436	1736							0911	1136	1436	1736						
Sampford Moor, Blue Ball Inn (SW-bound)	0920	1145	1445	1745							0920	1145	1445	1745						
Nicholashayne, opp Post Box	0924	1149	1449	1749							0924	1149	1449	1749						
Culmstock, All Saints Church (E-bound)	0729	0930	1155	1455	1755						0729	0930	1155	1455	1755					
Hemyock, Castle Park (NE-bound)	0738	0939	1204	1504	1804						0738	0939	1204	1504	1804					
Hemyock, Prowses (S-bound)	0741	0942	1207	1507	1807						0741	0942	1207	1507	1807					
Hemyock, Catherine Wheel (N-bound)	0743	0944	1209	1509	1809						0743	0944	1209	1509	1809					
Sheldon, Sheldon Turn (S-bound)	0749	0950	1215	1515	1815						0749	0950	1215	1515	1815					
Dunkeswell, opp Royal Oak	0753	0954	1219	1519	1819						0753	0954	1219	1519	1819					
Dunkeswell, Jenwood Road (W-bound)	0756	0957	1222	1522	1822						0756	0957	1222	1522	1822					
Combe Raleigh, opp Combe Raleigh Turn	0803	1004	1229	1529	1829						0803	1004	1229	1529	1829					
Honiton, Job Centre (Stop D)	0810	1011	1015	1236	1240	1536	1540	1836			0810	1011	1015	1236	1240	1536	1540	1836		
Honiton, Tesco Superstore (E-bound)	0820	1020	1245	1545	1841						0820	1020	1245	1545	1841					
Honiton, Waterleat Avenue (NE-bound)	0824	1024	1249	1549							0824	1024	1249	1549						
Wilmington, White Hart Inn (E-bound)	0830	1030	1255	1555							0830	1030	1255	1555						
Shute, Shute House (S-bound)	0839	1039	1304	1604							0839	1039	1304	1604						
Colyton, The Square (S-bound)	0846	1046	1311	1611							0846	1046	1311	1611						
Colyford, opp The Elms	0850	1050	1315	1615							0850	1050	1315	1615						
Seaton, Health Centre (S-bound)	0852	1052	1317	1617							0852	1052	1317	1617						
Seaton, Marine Place (Stop B)	0857	1057	1322	1622							0857	1057	1322	1622						



#### Seaton - Honiton - Hemyock - Taunton

Stagecoach South West

Timetable valid from 25/07/2016 until further notice.

Direction of stops: where shown (eg: W-bound) this is the compass direction towards which the bus is pointing when it stops

Mondays to Fridays											Saturdays									
Seaton, Marine Place (Stop B)	0900	1200	1500	1700							0900	1200	1500	1700						
Seaton, opp Health Centre	0904	1204	1504	1704							0904	1204	1504	1704						
Colyford, The Elms (NE-bound)	0908	1208	1508	1708							0908	1208	1508	1708						
Colyton, The Square (N-bound)	0913	1213	1513	1712							0913	1213	1513	1712						
Shute, Shute House (N-bound)	0920	1220	1520	1718							0920	1220	1520	1718						
Wilmington, opp White Hart Inn	0929	1229	1529	1726							0929	1229	1529	1726						
Honiton, Waterleat Avenue (SW-bound)	0935	1235	1535	1732							0935	1235	1535	1732						
Honiton, Tesco Superstore (E-bound)	0701	0938	1238	1538	1735						0701	0938	1238	1538	1735					
Honiton, Lace Walk (Stop C)	0705	0942	1242	1542	1739	1740					0705	0942	1242	1542	1739	1740				
Combe Raleigh, Combe Raleigh Turn (NW-bound)	0712	0951	1251	1551	1746						0712	0951	1251	1551	1746					
Dunkeswell, Jenwood Road (E-bound)	0719	0958	1258	1558	1753						0719	0958	1258	1558	1753					
Dunkeswell, Royal Oak (N-bound)	0722	1001	1301	1601	1755						0722	1001	1301	1601	1755					
Sheldon, Sheldon Turn (N-bound)	0725	1004	1304	1604	1758						0725	1004	1304	1604	1758					
Hemyock, Square (W-bound)	0733	1012	1312	1612	1806						0733	1012	1312	1612	1806					
Hemyock, Castle Park (NE-bound)	0735	1014	1314	1614	1808						0735	1014	1314	1614	1808					
Hemyock, Prowses (S-bound)	0738	1017	1317	1617	1811						0738	1017	1317	1617	1811					
Culmstock, opp All Saints Church	0748	1027	1327	1627	1820						0748	1027	1327	1627	1820					
Nicholashayne, Post Box (NE-bound)	0753	1032	1332	1632							0753	1032	1332	1632						
Sampford Moor, Vine Cottage (NE-bound)	0757	1036	1336	1636							0757	1036	1336	1636						
Wellington, Post Office (NE-bound)	0806	1045	1345	1645							0806	1045	1345	1645						
Silver Street, Heatherton Grange Inn (NE-bound)	0813	1052	1352	1652							0813	1052	1352	1652						
Taunton, Castle Way (S-bound)	0831	1105	1405	1705							0831	1105	1405	1705						

Data Provided by South West Public Transport Information (SWPTI) - 33 - 06/09/16

### BURLESCOMBE - TIVERTON Via Holcombe Rogus, Huntsham

### REDWOODS 697

#### Friday only (Except Public Holidays)

<b>HEMYOCK, Lower Millhayes</b>	<b>0910</b>	<b>TIVERTON, Bus Station Stand 6</b>	<b>1315</b>
HEMYOCK, Square	0912	TIVERTON, Carew Road	1321
CULMSTOCK, All Saints Church	0920	CHETTISCOMBE, Post Box	1323
CULMSTOCK, Millmoor	0922	CHEVITHORNE, Church	1325
BURLESCOMBE, Ayshford Arms	0930	UPLOWMAN, Bus Shelter	1332
WESTLEIGH, Shelter	0934	STAGG MILL, Cross	1337
<b>HOLCOMBE ROGUS, Prince of Wales</b>	<b>0942</b>	<b>HUNTSHAM, Post Office</b>	<b>1342</b>
HOLCOMBE ROGUS, Whitebrook Terrace	0944	HOCKFORD WATERS	1348
HOCKWORTHY, Phone Box	0950	STAPLE CROSS, Inn	1350
STAPLE CROSS, Inn	0952	HOCKWORTHY, Phone Box	1352
HOCKFORD WATERS	0954	HOLCOMBE ROGUS, Whitebrook Terrace	1358
<b>HUNTSHAM, Post Office</b>	<b>1000</b>	<b>HOLCOMBE ROGUS, Prince of Wales</b>	<b>1400</b>
STAGG MILL, Cross	1005	WESTLEIGH, Shelter	1408
UPLOWMAN, Bus Shelter	1010	BURLESCOMBE, Ayshford Arms	1412
CHEVITHORNE, Church	1017	CULMSTOCK, Millmoor	1420
CHETTISCOMBE, Post Box	1020	CULMSTOCK, All Saints Church	1422
TIVERTON, Carew Road	1022	HEMYOCK, Square	1430
<b>TIVERTON, Bus Station</b>	<b>1028</b>	<b>HEMYOCK, Lower Millhayes</b>	<b>1432</b>

*This service is financially supported by Devon County Council*

# St Andrew's Clayhidon

## In This Issue:

- ◆ St Andrew's News
- ◆ £10,000 grant
- ◆ Rosemary Lane News



## St. Andrew's Church News

During the summer months we have continued participating in services three times a week with people from Hemyock and Culmstock using zoom. It had been very enjoyable in many ways. At the end of August we sat on chairs in the churchyard and were delighted to be among friends for two short services. The first one, taken by our rector and David Major, was a conclusion to four Sundays of prayer for healing for our communities in the face of Coronavirus. The second service was a shortened service of Holy Communion led by the Rev John Stone.

Since September we have been meeting together inside our lovely church buildings once more. Sadly, the Horse Riders' service due to be held on 20 September had to be cancelled because of the new Covid 19 restrictions. The APCM, the annual general meeting for the church, could not be held earlier in the year because of the lockdown so it is planned to take place immediately after the Holy Communion service on 27 September. The 'Gift Day' which was on 29 August could not be attended by some in the parish but donations can still be contributed if you would like to contact our treasurer, Michael Osmond in Rosemary Lane. 01823-680606.

Our services for October and November will be found at the beginning of the Pump and will include Holy Communion on the second and fourth Sunday of each month, one at 8.30 am and the other at 10am. There will be extra services in October for **Harvest** and then in November for a baptism/christening and of course, to celebrate **St Andrew's Day**.

No doubt we have all been confused to some extent by the events of recent months, but we can think joyfully of happy occasions ahead and pray for the good health and welfare of all in our community, finding ways to support our family, friends and neighbours and offering our thanks for this opportunity to be drawn closer together in our lives.

*P. Reynolds, PCC*

## Government gives £10,000 to hall

Clayhidon Village Hall has won a £10,000 Government grant to help it through the COVID-19 crisis. Hall treasurer David Bearne applied for assistance under the Hospitality and Leisure Grant Scheme, which recognises that village halls will suffer a significant loss of revenue due to closure during the pandemic. The money will go towards hall maintenance and running costs.

David said he was delighted by the award and added special thanks to the Growth and Regeneration Officer at Mid Devon District, Council, who assisted with the application.

## Boot Sale & Table Top Sale

at

### Half Moon Inn



Saturday 24th October 10am - 1pm

Tables are available or bring your own. Cars and Parking in Church field also in Pub car-park, under our Stretch Tent & in the Skittle Alley.

Book ahead to reserve your space. £5 per car or Table. Setup from 9. Funds going towards Village Hall Reno-

PUB OPEN, SERVING	DE-CLUTTER
TEA/COFFEE BACON	DELETE
ROLLS THEN LUNCH	DE-STRESS
FROM 12.00	Then buy
	more stuff !

**Half Moon Clayhidon**  
EX15 3TJ  
Tel:01823 680291



They knew it was left over from the Harvest Festival, but not what it was, or where...

## News From Rosemary Lane Chapel

For most of us, we have been learning how to go about day-to-day life in new ways. Simple tasks now have to be thought through to make sure we comply with the latest advice, safeguarding both ourselves, and those we encounter. My usually haphazard meandering through the supermarket is a thing of the past. So, when the government announced that places of Worship could reopen after the 4th July, we took our time to think through how we would go about opening up the chapel. We wanted to ensure that, not only did we comply with the guidance, but that we set things up in a way that created a safe and encouraging place for the fellowship to gather again as a worshipping community.

After risk assessments had been completed, screens and sanitisers installed, seats appropriately set out and a one way system through the building implemented... we were finally ready to open on Sunday 9th August. As we opened up the chapel once more, we recognised that there would be some keen to attend immediately, and others who would, for the time, like to continue attending online. As such, our 11am service at Rosemary Lane was accompanied by an online sermon streamed through our YouTube channel on a Sunday morning, and a continuation to our midweek bible study group and Sunday Morning prayer group taking place online.

**"In a world of social distancing, it has perhaps never been so vital that we see our connectedness, the value of community."**

The first Sunday back at chapel was a rich blessing, especially to me, having spent the last few months preaching to a camera in an empty building. To worship together through new and creative ways, to read the word together and to be able to

support one another at this time is immensely important. Alongside our continued online presence, we give thanks to God for the blessings we each receive in fellowship. To be a community of believers sharing in the Love of the Lord is something we have had amplified as we have continued our series in the book of Acts which charts the growth and movement of the church out into the nations.

Attendance at chapel has grown over the past weeks and as I write this, we look forward to joining together in person at chapel and online to celebrate our harvest service which will be led by Richard Coles from St. Cleers Chapel in Somerton (20th September). Though we will greatly miss our Ploughman's Praise service this year, we give thanks that we have been able to continue in our harvest celebrations and reflect upon the Lord's provisions. Indeed, we share in thankfulness for the greatest provision of all:

*For God so loved the world that he gave his one and only Son, that whoever believes in him shall not perish but have eternal life – JOHN 3:16*

As we consider the riches of God's love for us, and for all that he has placed in our hands, we are grateful that we can share that which we have received. This harvest, as a chapel, we will be supporting the work of CHAT (Churches Housing Action Team). In particular the Food Bank which continues to be a support to those in need at this time. Further afield we have been glad to show support to the work of MAF (Mission Aviation Fellowship) and SAT 7 who support Christians across the Middle East and North Africa.

We would like to extend our love and greetings to the many members of the community who join with us through the BSG Luncheon and Tea Clubs, the young families who would attend Toddlers, the children who attend Venturers and the young people who attend Ignite. We miss you all and look forward to opening the chapel more widely in the future.

In a world of social distancing, it has perhaps never been so vital that we see our connectedness, the value of community. As a Church, we are challenged to find new and creative ways of communicating love for one another and, above all, to share in the riches of God's love that we discover in Jesus.

*God showed how much he loved us by sending his one and only Son into the world so that we might have eternal life through him. This is real love—not that we loved God, but that he loved us and sent his Son as a sacrifice to take away our sins. Dear friends, since God loved us that much, we surely ought to love each other.*

1 JOHN 4:9-11

If you would like to know more about our faith in the Lord Jesus, or about the fellowship at Rosemary Lane then please make contact with us. A warm welcome is extended to all - details of our services and what they look like during Coronavirus can be found on our website ([www.rosemarylanechapel.co.uk](http://www.rosemarylanechapel.co.uk)).

Jonathan Hillman

On behalf of the fellowship at Rosemary Lane Chapel  
[rosemarylanechapel@live.co.uk](mailto:rosemarylanechapel@live.co.uk)



## Our Thatching Life, Featuring Ferrari the Thatcher and a Turkey Baster of Sorts...

**H**aving been pursued with great vigour throughout lockdown, I now find myself building a nursery ... for piglets. It all began when Itchy started feeling amorous and took to chasing me round the pen, leaving me at one point perched on top of an old tyre still attached to the rusting chassis of one of Frank's old trailers that the pigs had uncovered, while Itchy circled and grumbled like a very hungry shark.

I had to leap the fence to save myself, slightly miffed that I must smell like old boar! I gave the matter some thought and besides changing my deodorant, decided to find Itchy a mate. Finding an actual boar would be tricky in lockdown, so it was off to the online shop for some saddle-back semen and the necessary equipment for artificial insemination which rather unhelpfully is threaded lefty tightly and righty loosely, counterclockwise. Mind you it came from Northern Ireland to my doorstep in 8 hours flat... speed dating for pigs.

Next to check if and when she was in 'standing heat'. When the gilt or sow is ready she will lock her back legs when weight is applied to her back. This mostly means sitting astride her facing backwards hoping she will stand while you work out your left from your right, only to find that for the first two days she was very much NOT ready, biting my legs, pushing me into the side of the pen. Third day: Sleeves rolled up, my old leather riding chaps on to spare my legs another going over, ready for another go at this weirdest of rodeos.... and finally... Success!

So now it's time to get the pen piglet ready; the gates boarded up at the bottoms, and the fences checked; the sows separated and the pig arc made up with fresh bedding; diary checked and checked again for the date... 3 months, 3 weeks, and 3 days from date night.

Tending to the pigs twice a day, I watched Itchy as she found her way towards motherhood, bidden by nature and instinct. She would run to fetch an apple, then pause as if trying to remember what thing it was she should be doing. She began nesting in earnest, every day dragging everything into her ark: a large limb from the oak tree, a hose pipe, 3 big chunks of concrete, the water trough...and every day I'd pull it all back out again for 3 days until she finally settled one lunchtime, lying still and calm; waiting. I decided to phone a vastly more experienced friend in case I'd missed something, or what to look out for if she was in trouble. Safe in the knowledge that he would come and help if it all went wrong, I worked the afternoon and then back to check on the old girl and see how she was getting along. Quite well as it turns out....12 piglets, twelve! All suckling, with Mother quiet as a lamb.

A day later, and 12 turned out to be 13, but one deceased. That said, Itchy is a calm and steady mother so far, moving slowly and adjusting to accommodate so many hungry mouths. I watch quietly from outside the ark, and watch as each piglet shuffles and snuffles and tries to find its way to the best teats at the front, constantly clambering one over the other like some piglet peloton.

There is a very great deal of thatching work to be done; every thatcher I speak to is flat out busy, and we are the same....but the piglets are joyful little time wasters all the same. New life.

## NEWS FROM COLDHARBOUR

### MILL

#### Making a Splash! Water, Wildlife and Wellbeing

**A**lthough the Museum is currently closed to the public, Coldharbour Mill Trust is very excited to be launching the plans for phase two of PROJECT SPLASH!



This community woodland and wetland project aims to regenerate the Millpond area, creating a wildlife haven and community space for everyone to enjoy.

We want to involve YOU in the planning and design of the new 10-acre Community Space and Industrial Sculpture Trail. We need members of the local community, schools and other groups to help co-create the new community space, so we are recruiting volunteers to help us deliver the design aspirations on the ground, getting input from all so the project can be as accessible and relevant as possible.

Your support will enable us to employ a part-time project coordinator and to provide volunteers with the skills training and equipment they will need for the project. This rural work-based expertise will help to improve volunteers' chances when seeking paid employment in the future. Alongside will be the development of countryside management and artisan skills such as dry stone walling, and management of water & wildlife.

You can show your support by giving your feedback, volunteering your time or donating to our crowdfunder! For more info about volunteering to help with the project, please email [info@coldharbourmill.org.uk](mailto:info@coldharbourmill.org.uk) or phone 01884 840960.

To support the Crowdfunder appeal, please go to the Mill website: [www.coldharbourmill.org.uk](http://www.coldharbourmill.org.uk) or to: [www.avivacommunityfund.co.uk/making-a-splash-1](http://www.avivacommunityfund.co.uk/making-a-splash-1) For more information about the project, to see the plan and a video, or to give feedback (by 31st October), please go to: [www.coldharbourmill.org.uk/projectsplash/](http://www.coldharbourmill.org.uk/projectsplash/)

**Coldharbour Mill Trust Ltd is Registered Charity No: 1123386**



## Blackdown Hills Transition Group

**A**n upside to the current crisis we are facing with Coronavirus has been the way the communities in the Blackdown Hills have come together to help and assist those who have been unable fend for themselves. The pubs have taken to becoming local shops and takeaways, neighbours have delivered essential goods and services including prescriptions to those unable to get out. It has galvanised community support networks in order to ensure as many of us as possible get through the crisis unharmed.

This working together and promoting community support networks is a fundamental requirement and an essential objective of the Transition movement in order to promote local sustainability.

### Blackdown Hills Transition Group's Community Fund.

The Blackdown Hills Transition Group through its various activities e.g. Repair Café and Apple days have been fortunate to be able to offer some small grants funded by donations at our events in order to support local environment improvements. We would like to thank everybody who has made a donation to make these small grants possible. Seven local groups applied and have each received £250 to progress their objectives. They are:

1. Churchstanton School local hedge regeneration project
2. Hemyock Primary School Kitchen Garden Project.
3. Blackdown Community Bus - Providing A Service To The Community.
4. Repair at Home and Skills Share Scheme

5. CBO news schools Climate Change project
6. Longmead Environmental Project Raised Bed
7. Hemyock Wildflower Verge Project

We have cancelled all future Repair Cafés until further notice

For more information and to volunteer your help, please email Stephan Lehner at [blackdownhillsrc@gmail.com](mailto:blackdownhillsrc@gmail.com) or phone 0771 546 0783.

All details are on our website at <http://www.blackdownhillstransition.net>.

## Friends of Otterhead

**T**he Otterhead Estate Trust is delighted to announce the formation of the "Friends of Otterhead". The site is managed (as a nature reserve) entirely by volunteers, but it is well loved by many visitors, so the Friends will offer the chance for people to get involved, contribute to projects and to have a say in the way that the estate is run.

If you would like to become a Friend of Otterhead and support our work, (cost £10pa) please contact Jackie Gage to find out more about the benefits and opportunities: [friendsofotterhead@gmail.com](mailto:friendsofotterhead@gmail.com), 07966 402391.

# CHRISTMAS TREES

**FREE delivery to your home**

Beautiful, non needle drop Nordmann Fir  
4, 5, 6, 7 and 8 foot trees available

Grown and delivered by an ethical, local company

**Order Online**  
For FREE home delivery or;

**Pick Your Own**  
Be welcomed to our nursery and choose your own tree with help from our warm and friendly staff.

For orders and information please visit:  
**www.pixtonchristmas.co.uk**  
Tel: 01398 331 724  
Email: [pixtonchristmas@gmail.com](mailto:pixtonchristmas@gmail.com)



[pixtonchristmas.co.uk](http://pixtonchristmas.co.uk)

**NHS THANK YOU!**  
Pixton Woodlands Ltd, South Molton Road, Bampton, Devon, EX16 9HU  
A generous percentage of our proceeds are donated to the Devon Partnership NHS Trust  
We also support the NHS Staff Discount Scheme  
\*T's & C's may apply

**The Filo Project**  
Community Interest Company  
A different kind of day care

The Filo Project is a ground-breaking not-for-profit organisation offering high quality adult day care. Our service supports elderly individuals who are socially and intellectually isolated, most of whom are experiencing symptoms associated with moderate dementia, including memory loss.

A day with The Filo Project begins when clients are collected from their own home by a host. The clients spend the day in the host's home between the approximate hours of 10am-4pm. Group sizes are small, generally a maximum of 4. The intimate home environment is key; no client is subsumed by a large group and confidence is gently nurtured. Moreover, the small group size gives the time and space for people to feel at ease, to flourish and to form friendships.

Apart from having a home-cooked lunch, what occurs in each group varies and is dependent on who is in a group and what the capacities and personalities are. It is a bespoke service. However, the focus of any day, for any group, is to provide the opportunity for high quality social interaction.

**DAY CARE HOST**

We are looking for intelligent, versatile and empathetic hosts. Hosts will be required, in their own homes, to meaningfully occupy and engage with a maximum of four older people who may be socially isolated and experiencing symptoms associated with moderate dementia, including memory loss.

- Hosts require a full driving license, downstairs W/C and access to a five-door car
- Experience isn't essential however, hosts must be; a good listener, gentle, able to 'read' people well and be understanding
- Full training is provided
- A DBS check is undertaken prior to work commencement.

The Filo Project is a lead provider for Devon County Council and hosts enjoy excellent rates of pay and on-going training. Please visit [www.thefiloproject.co.uk](http://www.thefiloproject.co.uk) for further details, or contact us on 01392 982138 or email [info@thefiloproject.co.uk](mailto:info@thefiloproject.co.uk)

For more information visit [www.thefiloproject.co.uk](http://www.thefiloproject.co.uk) or call us or email on 01392 982138 [info@thefiloproject.co.uk](mailto:info@thefiloproject.co.uk).

**MOBILE PRESSURE WASHING SERVICES**  
water supplied if necessary

**FULLY INSURED DOMESTIC AND COMMERCIAL**

12/18 inch surface cleaner - ideal for large areas, walls and floors

- DRIVEWAYS
- PATIO
- DECKING
- WINDOWS
- CONSERVATORY AND ROOF
- FACIA BOARDS
- GUTTERING
- ROOF
- CARAVANS
- FULL HOUSE CLEAN

**ALSO AVAILABLE**

- HEDGE CUTTING
- MOSS CLEANING
- FENCING
- CLEANING OUT GUTTERING
- ALL OTHER HANDYMAN SERVICE

01404 891890 07739 409903  
[ollystarr@outlook.com](mailto:ollystarr@outlook.com) Find me on Facebook

**UFFCULME ALLOTMENT ASSOCIATION**

Our sixty allotments are sited at the very top of Clay Lane. The site is well established and friendly. If you're interested in renting a plot (20m x 3.4m) and joining our *Grow Your Own* band, please contact us for details and to arrange a look around.

Contact : Pete Best mob: 07703 185040 e-mail: [petebestuk@yahoo.co.uk](mailto:petebestuk@yahoo.co.uk)

01984 623404 | [wci.co.uk](http://wci.co.uk)  
[enquiries@wci.co.uk](mailto:enquiries@wci.co.uk)

**Service, maintenance and repair of all types of sewage treatment plant and pumping equipment.**

All manufacturers. Domestic and commercial systems.

Emergency Call Outs. Biennial diarised visits. Annual Service Contracts with a Service Level Agreement.

**Call or email us today to arrange a service visit or discuss your options**

British Water Accredited Service Engineers.

- ✓ Responsive
- ✓ Professional
- ✓ Fully Insured
- ✓ Family Run



**Wellington**  
The Mount Veterinary Hospital,  
Taunton Road, Wellington, TA21 9FG  
01823 662286

**24H EMERGENCY SERVICE | Overnight nursing care | Modern, comfortable air conditioned wards | Certificate holders in surgery, medicine and ophthalmology**

**MOUNT Active PET HEALTH CLUB**

**VALID UNTIL 31ST JAN 2020**  
QUOTE "HOLLY19" FOR YOUR FIRST MONTH FREE\*

**Dogs & Cats**  
**From £13.15 /month**

- Annual health check & booster
- Six month vet check
- Flea treatments\*\*
- Worming treatments\*\*
- 20% off selected food products
- Discounted dental scale & polish
- Free microchipping
- Free nurse clinics (incl. nail clippings)
- 10% discount on lots more!

\*\*Sufficient for 12 months.

\*The Pet Health Club is a 12 month contract and you are therefore required to pay the remaining 11 months on a direct debit basis. Payments will start the month following the plan's first free month. Cancellations of The Pet Health Club are subject to full payment of any benefits already received from the plan. This offer is subject to new customers only and cannot be redeemed for any cash value. Offer valid until 31st January 2020.



# Bunyan Plumbing & Heating



01823 681580  
07854 264065

E-mail: [ian.bunyanplumbing@googlemail.com](mailto:ian.bunyanplumbing@googlemail.com)



DAIRY COTTAGE  
STATION ROAD  
HEMYOCK  
EX15 3TZ

From dripping taps to full heating installation

Boiler services and Landlord gas check, oil & gas

Bathroom design and tiling services available

## Kingsmead Centre

Relaxing Breaks in the Devon & Somerset Countryside

Need somewhere for your friends and relatives to stay while they visit you?

Our small, family run campsite offers a range of accommodation:

- Grass Pitches for Tents
- Hard-standing for Motorhomes and Tourers
- Woodland Pitches with Firepits
- Static Caravans
- Glamping Options

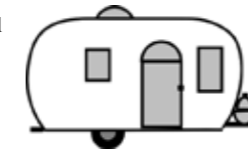

Join us for Cream Tea Afternoons and Takeaway Pizza Nights during the Summer – everyone Welcome  
(Check our website for dates)

Open all year round for motorhomes and static caravans

Discounts available for locals

Kingsmead Centre, Forches Corner, Clayhidon,  
EX15 3TR

[www.kingsmeadcentre.com](http://www.kingsmeadcentre.com)

01823 421630



01884 829464 **Appleyard's** 07868 589525

**CHIMNEY SWEEPING & SERVICES**

Wood-burning Stoves  
Multi-fuel Stoves  
Open Fires  
Aga/Rayburn  
Gas & Oil Flues



REGISTERED MEMBER  
[www.instituteofchimneysweeps.co.uk](http://www.instituteofchimneysweeps.co.uk)

REGISTERED MEMBER INSTITUTE of CHIMNEY SWEEPS  
FRIENDLY, CLEAN & SAFE SERVICE  
PUBLIC LIABILITY INSURANCE £5M  
INSURANCE CERTIFICATES ISSUED WITH EVERY SWEEP

Removal of bird nests  
Resealing of appliance components  
Replacement rope seals, fire cement seals and fire bricks  
[www.appleyardschimney.co.uk](http://www.appleyardschimney.co.uk)

## Kittow Cattle Meat Boxes

Chapel Cottage, Culm Davy, Hemyock, Devon.

Quality, competitive, convenient, delivered to your door!

Angus Beef	30 lb /13.6 kgs	£150
Wessex Pork	30 lb /13.6kgs	£ 95
Mixed Box	30 lb /13.6 kgs	£125
Mini Boxes	15lb/6.8kg from	£ 50



Each box can be made up especially for you with only the cuts you enjoy!

Prices, cuts and weights might alter slightly as each animal is different.

For more details please call 01823 680 971  
or visit [www.kittowcattle.com](http://www.kittowcattle.com)



Oaktree Court  
by Majesticare

## Oaktree Court

Oaktree Court is a 56 bed home providing **care for residents who require personal, nursing or dementia care.**

The home is part of The Majesticare group and sits just off of the main A38 between Wellington and Tiverton and is set in 7 acres of beautiful grounds. **Companionship and real family values are at the heart of Oaktree Court** and they want everyone who visits their home to **feel welcome and at home.**



If you are looking for care for yourself or a loved one and **enjoy the outdoors, beautiful gardens and in a peaceful location with a warm atmosphere**, Oaktree Court may well be the home for you.

Contact Home Manager Marie George for more information on **01823 662032** or do visit for a tour of the home and grounds.

Oaktree Court, Middle Green Road,  
Wellington, TA21 9NS.





## New Street VETS



# Your friendly, local Small Animal Veterinary Practice

**Honiton Branch**  
62 New Street  
Honiton  
EX14 1BZ  
01404 42750  
[www.newstreetvets.co.uk](http://www.newstreetvets.co.uk)

**Hemyock Branch**  
Unit 1c Station Rd Ind Est  
Hemyock  
EX15 3SE  
01823 681067  
[office@newstreetvets.co.uk](mailto:office@newstreetvets.co.uk)

Consultation by appointment only – 24 hour Emergency

Proud members of  
**Checkatrade.com**  
where reputation matters



★ Trustpilot



Everything  
**Plumbing  
& Heating**

Email: [info@synergisw.co.uk](mailto:info@synergisw.co.uk) Website: [synergisw.co.uk](http://synergisw.co.uk)

- ✓ **New Boilers**
- ✓ **Heating Systems**
- ✓ **Boiler Servicing**
- ✓ **Plumbing**
- ✓ **Gas, Oil, LPG**
- ✓ **Boiler Repairs**

**24 Hour Availability**  
**Call: 01404 234 363**



## In Pain? Don't Struggle On!

Experienced osteopath Martha Price can help

Appointments available at The Blackdown Healthy Living Centre Hemyock - call 07734 431624 and Lusson Surgery, Wellington - call 01823 662836

Sports Injuries  
aches and pains from  
gardening

arthritis  
back pain  
sciatica

shoulder injuries  
irritable babies  
...and more



**Martin & Lee**  
ASSOCIATES LTD.

Chartered Town Planning Consultancy



Planning & Development



Assessments



Project Management

Professional Chartered Town & Country Planning Consultants based in Devon with over 27 years of combined experience in private practice and local authority.

[www.martinsleeassociates.com](http://www.martinsleeassociates.com)  
Wyndham, Station Road, Hemyock, EX15 3SE  
t: 01823 680 306 m: 07710 229 580  
[martinstuartlee@gmail.com](mailto:martinstuartlee@gmail.com)

## TIME FOR A CHANGE!

LOSE WEIGHT....SHED THAT PHOBIA....STOP SMOKING....STOP FEELING WORTHLESS  
BE SOCIALLY CONFIDENT...GET FITTER...STAND UP FOR YOURSELF  
OVERCOME FEAR...SHED THE STRESS...IMPROVE THE RELATIONSHIP  
PERFORM THE WAY YOU KNOW YOU REALLY CAN...MANAGE PAIN  
BE CONFIDENT IN EXAMS...FORGET WHAT HAUNTS YOU.

\*Clinical Hypnotherapy has been used for all these purposes and many more. It is relaxing, gentle, and safe. You remain in control of yourself. You cannot get stuck in hypnosis. Thousands benefit from it every year.

\*On the other hand, you might want to use Painless Spinal Touch to deal with your back pain, stiffness, or stress.

\*Or Mora or Skenar bioresonance treatment to deal with a wide range of problems like IBS, low energy, M.E., or food allergies and sensitivities.

**For a free confidential discussion of your requirements and what course of action might best suit them, call:**

**RICHARD MURPHY**

Clinical Hypnotherapy and Bioenergetic Medicine  
01404 891688

[richard-murphy.co.uk](http://richard-murphy.co.uk)

Practising at the Hypnotherapy Centre, 35, Fore Street, Wellington

**BLACKDOWN**

FAMILY LAW SOLICITORS

Solutions for marriage and relationship breakdown



22  
year

qualified respected local divorce specialist

55%

of the cost of most other  
senior family law solicitors

FREE

one hour initial consultation

7  
days

a week, evening availability

Divorce • Financial Settlements • Separation • Children • Pension Claims •  
Cohabitation Claims • Child Support • Civil Partnerships • Pre- Marital & Cohabitation Agreements

**resolution**  
first for family law

**Tel: 01823 478470**

[www.blackdownfamilylaw.co.uk](http://www.blackdownfamilylaw.co.uk) • e: [info@blackdownfamilylaw.co.uk](mailto:info@blackdownfamilylaw.co.uk)

Pencross Chambers, Honeysuckle Cottage,  
Pencross, Hemyock, Devon EX15 3SR



**PETER BROWN**  
PROPERTY MAINTENANCE

**PAINTING & DECORATING SERVICES**

TEL: 07796 174145

EMAIL:  
[pandsdecorating@hotmail.co.uk](mailto:pandsdecorating@hotmail.co.uk)



**ASHCULME**  
framing

Bespoke framing  
Please call for a quote or make an appointment to visit.

T: 0755 700 2765  
E: [ashculmeframing.co.uk](mailto:ashculmeframing.co.uk)  
[www.ashculmeframing.co.uk](http://www.ashculmeframing.co.uk)  
The Studio, Studleys, Ashculme, Hemyock, Cullompton, Devon EX15 3SU



**The Blackdowns Business Centre**

*Do you work from Home? Do you need secretarial assistance?*

**Telephone Answering** – A dedicated number answered in your company name with calls forwarded to you or messages taken/forwarded.

**Meeting Rooms** – Hold your business meeting in a professional environment rather than your home.

**Secretarial Services** - Full range of secretarial services, e-mail handling, copying, etc.

**Offices to rent** -Daily, weekly or longer

**Business address** – professional office address for delivery of post and parcels

We offer a range of services tailored to your individual needs

**Call in for a chat or call us on 01823 478255**

**Halifax House, Station Road, Hemyock, EX15 3QW**  
[admin@blackdownsbc.co.uk](mailto:admin@blackdownsbc.co.uk)  
[www.blackdownsbc.co.uk](http://www.blackdownsbc.co.uk)



**Kent Farm**  
Residential Home

Mill Street, Uffculme, EX15 3AR



**Facilities**

- 21 registered single rooms 12 of which are en-suite rooms.
- 2 adapted disabled respite rooms with full wet room.



**About**

- NVQ Level 2, 3 & 4 trained staff provide 24 hour care.
- Family and friends involvement is supported and encouraged.
- All residents at Kent Farm have individual care packages focused on the persons individual needs.



**Personal Care**

- Day care and respite care.
- Group activities and entertainment sessions (see our website for more).
- Twice weekly massage sessions.
- Access to a GP of choice for each patient.
- A spacious main communal lounge.
- Recliner chairs, a large screen TV, DVD and radio/CD.
- A private 'quiet room' for our clients and their visitors.



**Contact Us**

01884 840144  
[enquiries@kentfarm.co.uk](mailto:enquiries@kentfarm.co.uk)  
[www.kentfarm.co.uk](http://www.kentfarm.co.uk)  
Manager: Mrs Jacky Holland

**HAVE A REAL CONVERSATION TO HELP YOU PLAN YOUR FUTURE**

Having a local office means we are accessible and on hand to understand your needs, because time spent on a real conversation allows us to appreciate the finer details.

Call 01884 253550 or pop in, Key House, 4 Woodward Road, Howden Industrial Estate, Tiverton, Devon, EX16 5GZ



Agent of The National Farmers Union Mutual Insurance Society Limited.

**TRY OUR PAYMENT PLAN**  
3, 6, 9 or 12 months  
THE EASY WAY TO PAY

**RIDGE ROOFING LTD**

**& SCAFFOLDING SERVICES**

**ALL ASPECTS OF ROOFING UNDERTAKEN - FROM LEAKY ROOFS TO RE-ROOFS**

Ridge Roofing Ltd is a well-established company with over 25 years' experience behind them, working in partnership with most of the leading estate agencies.

- Slating • Tiling • Flat roofing • Fibreglass flat roofs • Chimneys/Leadwork • Turnerized slate roofs • Guttering/uPVC/fascia boards
- Storm damage/insurance work • All grant work undertaken
- Insurance backed guarantees • Full public liability insurance
- Free written quotations • All work guaranteed



**AT THE TOP FOR BOTH QUALITY & PRICE**

Guaranteed to beat any genuine produced quote

**T: 01404 891813 M: 07789 555685 • [stephen.wattsrr@gmail.com](mailto:stephen.wattsrr@gmail.com) • [www.ridge-roofing.com](http://www.ridge-roofing.com)**





# Dobles of Hemyock



Proprietor Geoff Clist

## MOTS

SERVICES AND REPAIRS TO ALL MAKES

DIAGNOSTIC SERVICES

BODY REPAIRS

INSURANCE WORK UNDERTAKEN

BOSCH SERVICE CENTRE

### OPENING HOURS

MONDAY TO FRIDAY 8.30 – 5.30

SATURDAY MORNINGS

Station Road, Hemyock, Cullompton, Devon EX15 3SE

01823 680 233 Fax: 01823 680525

EMAIL: [service@doblesgarage.co.uk](mailto:service@doblesgarage.co.uk)



## Connetts Farm

### Dunkeswell

(in the old village, beside the church)

Potatoes (free local delivery, full or 1/2 bags)

Fresh, free-range eggs (£1 x 1/2 doz.)

Pork (from our own pigs)

\*

Logs

Small bales straw & hay

\*

#### ATTENTION GARDENERS:

Mushroom compost, woodchip, topsoil

(all at £2 per bag)

Farmyard horse & chicken manure, wood-chip mulch (just £1.50 per bag)

All approximately 25kilos—available in bulk, by the ton or cm3.

Topsoil & compost is sieved or screened producing a lump-free, stone-free product.

Bulk orders can be mixed e.g.

1/3 topsoil—1/3 manure—1/3 compost

Delivery cost calculated per mile with a maximum order of 50 bags

Nick: 07860459745

Heather: 07809870230

CONTACT US: 



AK Property Service

Annette Kirk MARLA

Property Consultant

Hemyock

07968 529321

Email: [enquiries@akpropertyservice.co.uk](mailto:enquiries@akpropertyservice.co.uk)

#### LANDLORDS:

- Let me review your current tenancies.
- Are you complying with legislation
- Fully Managed and Tenant Find Only Services
- How much is your current agent costing you!

Just a phone call can put your mind at rest!

arla | propertymark

PROTECTED



Window Cleaning Services

# Gleam

Reliable Friendly Service Guaranteed

#### WHY CHOOSE GLEAM:

- \_ Text notification service
- \_ Uniformed
- \_ Local
- Year round service, you choose the frequency
- Fully Insured
- Member of the British Window Cleaning Academy

#### SERVICES WE OFFER:

- Interior/Exterior
- Facias and Soffits
- Gutter cleaning and emptying
- Solar panels
- Conservatories
- Carpet cleaning/Power washing



Windows Cleaned by our Reach & Wash System and Gutters emptied with our Gutter Vac, all from the safety of the ground!

Gleam Window Cleaning Services- Contact Fran Webber-Rookes

Tel: 01823 338722/ Mob: 07788 748617/ Email: [gleamsomerset@gmail.com](mailto:gleamsomerset@gmail.com)

Made with PosterMyWall.com

## Blackdown Buildings

Buy direct from the sawmill

“Wood, the sustainable building material

of the future”

Established in 1981 We are your local supplier/manufacturer for:-

- Fencing Posts, Panels, Trellis, Gates, PostMix
- Garden Sheds Curved top, Pent or Apex roof, Made to measure or off the shelf,
- Leisure Shepherd Huts, Leisure Arks,
- Equine Stables, field shelters, American Barns, Shavings, Pellets
- Heating Biomass Fuel, wood pellets, Briquettes, Logs Coal
- Home/Business Garages, Bin stores, Dog Kennels, Decking, Sleepers, Picnic Benches,
- Small Holder Pig Arks, Poultry & Duck Houses, Animal Shelters, livestock housing
- Agriculture Portal frame buildings, Stakes, Posts, Rails Purlins, cladding, wire products
- Construction Over £1m worth of timber stock in various sizes and lengths, Joinery, Timber cladding Plywood, OSB, MDF Chipboard,, Cement , Nails, Bolts, Joist Hangers PIR (Celotex) and Wool Insulation etc

## Brookridge Timber



Contact us on 01823 681 603

[www.blackdownbuildings.co.uk](http://www.blackdownbuildings.co.uk)

or pop in and see us at

Fourways Cross Hemyock EX15 3PF

open Monday –Friday 8am to 5pm

Saturday 9am to 1pm



### THE CATHERINE WHEEL

Hemyock, Collumpton, Devon EX15 3RQ

Tel: 01823 680 224

Home Cooked, locally sourced food  
Seasonally inspired dishes  
All dietary needs catered for

Cask Ales, Draught Lager and Wines by the Bottle or Glass

Separate Dining Room, Bars, Function Room and Skittle Alley

Open Seven Days a Week:

Food Served: Tues—Sat 12-2.30pm and 6.30-9pm

Sunday and Bank Holidays: 12-2.30pm

Takeaway Service: Wednesday—Saturday 6.30-9pm

www.catherinewheelhemyock.co.uk  
www.facebook.com/thecatherinewheelhemyock

### HILARY NORMAN Foothealth Practitioner RFHP

#### GENERAL FOOT CARE

Nail Cutting & filing, Corn & Callus removal,  
ingrowing toenails, fungal infections and  
general advice on the care of your feet.

Weekly Clinic at Blackdown Centre  
plus home visiting service available

01823 481160  
07969 448793

hilary.norman@btinternet.com



The Devon Ceilidh Band For All Occasions

See our new website: [slackmagirdle.net](http://slackmagirdle.net)

Find us on Facebook

for more details or to contact us:

01404 823083 [empal1@icloud.com](mailto:empal1@icloud.com)

New look, same great ceilidh band for all  
occasions!

# MS HEATING

## QUALIFIED PLUMBING AND HEATING ENGINEERS

TELEPHONE (01884) 841334  
FAX: (01884) 841554

Prop: Marcus Smith

- Qualified H.E.T.A.S. Registered - Flue Liner & Log Burner Installations
- Qualified Worcester BOSCH SOLAR Engineers
- Underfloor Heating and Unvented Cylinders
- Boiler Efficiency testing and Free Energy Efficiency Advice
- Gas and Oil Boiler Installations, Servicing and Breakdowns



Tel/fax 01823672426

### P. J. Palfrey

Mobile: 07836549114

#### PLANT HIRE CONTRACTORS

SITE EXCAVATIONS FARM DITCHING GROUNDWORK

2 Chitterwell Cottages Thorne St. Margaret, Wellington Somerset TA21 0HF



FOR HIRE  
180° & 360°  
Dumpers



GROUNDWORKS, LARGE OR SMALL,  
DRAINAGE, FOUNDATIONS,  
LANDSCAPING

### Philip Parker & Son

#### Oil Fired Central Heating Engineers Servicing, Repairs & Boiler Replacements

Elm Meadow, Blagdon Hill, Taunton

Tel: 01823 421205

www.philipparkerandson.co.uk

email: [service@philipparkerandson.co.uk](mailto:service@philipparkerandson.co.uk)



Engineer Living In Local Area

### Patti O'Brien Acupuncturist

Lic Ac, BSc (Hons), MBACC

Are you in pain?  
Anxious?  
Under-performing?  
Unsure of the cause of  
your ailment or distress?

Book a  
FREE 20 MIN CONSULTATION  
with a fully qualified practitioner

Thursday clinic 9.30am-7pm  
Blackdown Healthy Living and  
Activity Centre, Hemyock,  
EX15 3SH

Mob: 07582 938055  
E: [info@eqacu.co.uk](mailto:info@eqacu.co.uk)  
[exeterquaysideacupuncture.co.uk](http://exeterquaysideacupuncture.co.uk)



## Milford & Dormor SOLICITORS

**SOLICITORS HEMYOCK**  
Need legal Advice?  
**FREE: Initial 1/2 hr interview**

We attend Halifax House (opposite Parish Hall) every Thursday morning and home visits can also be made available.

For appointments please telephone:

**Hemyock**  
01823 681300  
or  
**Chard**  
01460 61000

Offices also at:  
Axminster, Seaton (Devon) or  
Chard, Ilminster, (Somerset)

Registered by the Solicitors Regulation Authority (SRA No 52245)

## GARDEN HELP

Would you like help around the garden?

Call Henry Farrant on  
**680 281 07596716356**

### Mid Devon District Citizens Advice Bureau



We can come to you if you can't get to us.

Call: **01884 253688**

Speak to our outreach worker to make an appointment  
SUPPORTED BY THE COMMUNITY FUND

## WE HAVE A REAL CONVERSATION TO HELP YOU PROPERLY PLAN YOUR FUTURE

Investments from NFU Mutual. Call 01884 253550 or pop in.

NFU Mutual Financial Advisers advise on NFU Mutual products and selected products from specialist providers. When you contact us, we'll explain the advice services we offer and the charges.



Agent of The National Farmers Union Mutual Insurance Society Limited.



## Plumbing & Heating

Southwoods Farm  
Ashill  
Cullompton  
Devon  
EX15 3NS

Phone: **01884 841130**  
Mobile: **07860 441510**

### No call out charge

- All aspects of plumbing & heating
- Boiler, Aga & Rayburn servicing
- Gas, Oil, LPG & Solid Fuel
- Bathroom installations
- Gas Landlord Safety Certificates
- Under floor heating
- Free estimates



Contact Neil Thomas

[www.njtplumbingandheating.co.uk](http://www.njtplumbingandheating.co.uk)

Email: [neil@njtplumbingandheating.co.uk](mailto:neil@njtplumbingandheating.co.uk)

### Professional footcare

Experienced and registered practitioner.

Susanne Crofar  
MCFHP MAFHP  
Home visits by appointment.

For information and bookings  
Phone 01404 892868

Email: [susannecrofar@yahoo.co.uk](mailto:susannecrofar@yahoo.co.uk)

Reiki and Reflexology treatments also available.

Member of the  
Westcountry Natural Healing Fellowship.

## LOGS+TREE SURGERY

- dry, seasoned logs
- large or small quantities
- cut & split as required
- tree care, felling & lopping
- plant & trailer hire



Carl Westcott  
t: 01823 210678  
m: 07973 564759

## BKELECTRICAL



### ELECTRICAL CONTRACTORS

Contact us for a free quotation

**01823 681546 - 07766 732279**

[info@b-k-electrical.co.uk](mailto:info@b-k-electrical.co.uk)

[www.b-k-electrical.co.uk](http://www.b-k-electrical.co.uk)



Domestic and Commercial  
Industrial  
New Builds  
Rewires  
Internal and External Lighting  
Fuseboard Changes  
Telecoms/Data  
Inspection and Testing

## Did you know...

Mid Devon District Council fund a loan scheme for homeowners, for essential home repairs and improvements?\*

For more information, visit [www.wrcic.org.uk](http://www.wrcic.org.uk), call 01823 461099, or email [enquiries@wrcic.org.uk](mailto:enquiries@wrcic.org.uk)

Your local, not for profit lender working in partnership with Mid Devon District Council  
**Wessex Resolutions CIC**  
Heatherton Park Studios, Bradford on Tone, Taunton, TA4 1EU

\* Subject to Status

## Land management for non-farmers

- Hedging, ditching, draining and all types of fencing
- Unwieldy gardens, hedges and fences restored
- pasture management (topping, spraying, rolling, liming & re-seeding)
- groundworks, drives, gateways, concreting yards
- welding repairs and steel fabrications
- storage, containers and yard

We have the machinery and expertise to tackle most estate management problems – both big and small – from five practical farmers. Just ring for free quote.

**Five Farmers**  
Countryside Management Ltd

01460 234472  
[www.fivefarmers.co.uk](http://www.fivefarmers.co.uk)

## Windows and Doors

Timber - Conservation - Timber Alternative - Aluminium



If you are looking for inspiration, our superb showroom showcases undoubtedly the area's most extensive collection of windows and doors.



Have total peace of mind, you won't make a better call today.

TEL: 01404 41999  
Reme Drive, Heathpark, Honiton. EX14 1SE  
[www.duralifewindows.co.uk](http://www.duralifewindows.co.uk)



## IMAGES HAIR SALON



### OPENING TIMES

MONDAY 9AM - 3PM  
WEDNESDAY 9AM - 6PM  
SATURDAY 8AM - 6PM

Tel : 01823 680531

Over 25 years experience, all services available, cutting, colouring, perming, restyling, wedding/prom hair. If you would like an appointment any other time please ring and leave a message and I will return your call. We also do home appointments, please ring to book.



### The South West's trusted mover...

We are setting the standard for removals in Exeter and Devon by providing a professional, high quality service, while offering great value for money. We work locally and nationally and can offer a full or part pack service to compliment your removal.

Give us a call today to arrange a free no-obligation removal assessment!

01392 956 002

01884 665 000

[info@vanmanexeter.co.uk](mailto:info@vanmanexeter.co.uk)



[www.vanmanexeter.co.uk](http://www.vanmanexeter.co.uk)



## LINDEN HOUSE NURSING HOME



Linden House has been established as a Nursing Home for over 30 years and offers the highest standards of care

This 18<sup>th</sup> Century house is situated in 7 acres of peaceful and secluded parkland. We provide our residents with a homely and informal atmosphere and high standards of nursing care.

For further information or to view our home please contact Anne Troake on

01823 667711 or visit our website at [www.linden-house.net](http://www.linden-house.net)

or find us on Facebook





## FOR A COMPLETE BUILDING SERVICE QUALITY, RELIABILITY AND PEACE OF MIND ASSURED

**CALL 01884 840 037 or 07778 899 685 for a FREE estimate**

12 Kitwell Street, Uffculme, Cullompton, Devon EX15 3AP  
email: [taklebuilding@btinternet.com](mailto:taklebuilding@btinternet.com)



## Reflexology

**a balanced body is best placed to do its own healing, restoration and repair**



Massaging specific reflexes on the feet and/or hands encourages the body to regain wellbeing & balance, releasing stress & tension, improving mood & circulation, aiding sleep, & unblocking nerve impulses

- 'Fantastic firm confident pressure, energising & relaxing at the same time.' Julia
- 'The most deep and mindful experience I've had for years. Emma has the most reassuring & therapeutic manner.' Tony

**For further information or to book call: Emma Finch IIR MAR - m: 07957 161748  
e: [info@meaningfulsoles.com](mailto:info@meaningfulsoles.com) - [www.meaningfulsoles.com](http://www.meaningfulsoles.com)**

Clinic: The Healthy Living & Activity Centre, Hemyock - Home visits also available



## D.R. COCKCROFT

Roofing contractor & general building

WILLOW LODGE, PAY WOOD, STAPLEY, TAUNTON TA3 7QA  
Tel: 01823 601627 Mob: 07754 959847

## Play • Learn • Grow Together



CULMSTOCK  
PRE-SCHOOL  
PLAYGROUP

Registered Charity No. 297622

With one member of staff to every 5 children, and a maximum of 10 children per session, we create a unique and caring home from home environment

Fantastic garden/outside area  
Highly qualified, enthusiastic and experienced staff  
Lunch Club facility available

[www.culmstockpreschool.org.uk](http://www.culmstockpreschool.org.uk)

### Pounds

Farmhouse Bed and Breakfast

Ensuite king or double and twin rooms, within half a mile of Hemyock



Enjoy tea on your arrival, then wander around the lovely gardens and perhaps have a swim in the outdoor pool.

Wake up to a stunning view and come down to a hearty breakfast of fresh fruit and yogurt, locally farmed, free range sausages and bacon, with eggs from our own hens.

Finish off with delicious home made bread and marmalade.

Each room has tea, coffee and hot chocolate and a TV with DVD. Wi Fi throughout the house, in the front garden and beside the pool.

B and B is from £40 per person per night.

Diana and Jim Elliott, Pounds, Hemyock, EX15 3QS  
01823 680802 [www.poundsfarm.co.uk](http://www.poundsfarm.co.uk)

For the self catering cottage, please see [www.shillingscottage.co.uk](http://www.shillingscottage.co.uk)

## HARVEY & WADE LTD

Hand Crafted Fitted Kitchen Furniture  
(Craftsmanship/Unique/Inspirational/Timeless)

All Made in the UK  
Complete Project Management  
Bespoke Design Package  
Full Installation Service

Showroom in Honiton

38 High Street, Honiton, Devon, EX14 1PJ - 01404 41655

Website: [www.harveyandwade.co.uk](http://www.harveyandwade.co.uk)

Email: [sales@harveyandwade.co.uk](mailto:sales@harveyandwade.co.uk)

## Culm Valley Firewood Seasoned Hardwood Logs

# 01884 32940

Your Local Log Supplier  
[www.culmvalleylogs.co.uk](http://www.culmvalleylogs.co.uk)

## PURE OIL SERVICING

Copper Cavern • Denners Way • Uffculme • Devon • EX15 3XG  
Telephone 01884 840772 \* Mobile 07766 666960

Richard Sanders: Oil Servicing Specialist

CONTACT US FOR SERVICING AND BREAKDOWNS  
OF ANY OIL APPLIANCE TO INCLUDE THE FOLLOWING:-



- > AGA'S
- > RAYBURNS
- > OIL BURNERS
- > STANLEY COOKERS
- > OIL STOVES



Experienced Gardener undertakes all aspects  
of Garden maintenance. Blackdown's based.  
REFERENCES AVAILABLE.

CHARLES  
GARDEN  
SERVICES



Tel 07971 941 827



## CHIMNEY SWEEP

Tim Herman

07543 506652

- ✓ Insurance approved certificates issued
- ✓ Public liability to £5 million
- ✓ CCTV inspections
- ✓ Birds nests / blockages removed
- ✓ Fire rope replaced /stoves serviced
- ✓ Fire bricks replaced
- ✓ Carbon monoxide alarms installed

[tim@blackdownchimneysweep.co.uk](mailto:tim@blackdownchimneysweep.co.uk)  
[www.blackdownchimneysweep.co.uk](http://www.blackdownchimneysweep.co.uk)





## Clubs & Associations Contacts

<b>ACORN CLUB (OVER 60'S)</b>	<i>Val White</i>	681020	
<b>BADMINTON CLUB (HEM)</b>	<i>Mrs S Phillips</i>	680652	
<b>BLACKDOWN HEALTHY LIVING CENTRE</b>	<i>Centre Manager Peta Dayus-Jones</i>	680687	
<b>BLACKDOWN HILLS BUSINESS ASSOC.</b>	<i>Gemma Sparks</i>	07826 581365	
<b>BLACKDOWN SUPPORT GROUP</b>	<i>Elizabeth McNabb</i>	681036	d-ccg.bsgadmin@nhs.net
<b>BLACKDOWN SURGERY</b>	<i>Hemyock Reception</i>	680206	
<b>BOWLS CLUB</b>	<i>Jo Blackmore</i>	680868	
<b>BROWNIE GUIDES</b>	<i>Anne Leigh-Mallory</i>	680691	
<b>BRIGHTSIDE</b>	<i>Janet Elworthy</i>	680687	
<b>CAMEO CLUB</b>	<i>Manager: Tracey Howe</i>	680687	
<b>CLAYHIDON COUNCIL</b>	<i>Maurice Bendle</i>	680401	maurice.maureen@btconnect.com
<b>CLAYHIDON COUNCIL</b>	<i>Clerk: Donna Evans</i>	680968	
<b>COUNTY COUNCILLOR</b>	<i>Ray Radford</i>	01884 820000	
<b>CLAYHIDON FRIENDS</b>	<i>Anne Langford</i>	680086	
<b>CLAYHIDON HALL</b>	<i>Caroline Bendle</i>	681047	
<b>CLAYHIDON HISTORY</b>	<i>Pam Reynolds</i>	680481	
<b>CLAYHIDON TODDLERS</b>	<i>Karen Menzfeld</i>	680040	
	<i>Philippa Brooke</i>	680984	
<b>CRICKET CLUB</b>	<i>John Hurley</i>	07972 744279	
<b>DEVON HIGHWAYS</b>	<i>(8am – 8pm Mon–Fri, 9am–1pm Sat)</i>	0345 155 1004	
<b>DISTRICT COUNCILLOR</b>	<i>Simon Clist</i>	07855 027595	
<b>FOOTBALL CLUB</b>	<i>B. Churchill</i>	681271	
<b>GARDENERS ASSOCIATION</b>	<i>Susan Scantlebury</i>	681393	
<b>HEMYOCK SINGERS</b>	<i>Monica Smith</i>	681161	
<b>HEMYOCK CHURCH ROOMS (BOOKINGS)</b>	<i>Mrs J Bawler</i>	jbbawler1947@hotmail.co.uk	
<b>HEMYOCK HISTORY &amp; ARCHIVING ASSN.</b>	<i>Mike Cooper</i>	680175	
<b>HEMYOCK PARISH COUNCIL</b>	<i>Tim Barton</i>	681668	tim.barton123@gmail.com
<b>HEMYOCK PARISH COUNCIL</b>	<i>Clerk: Donna Evans</i>	680968	
<b>HEMYOCK PARISH HALL</b>	<i>Sharon Mitchell</i>	478255	
<b>HEMYOCK TENNIS CLUB</b>	<i>Bob Hawkes</i>	680047	
<b>HEMYOCK YOUTH FOOTBALL</b>	<i>Neville England</i>	01884 35744	
<b>HEMYOCK WI</b>	<i>Lyn Taylor</i>	680104	
<b>MEMORY CAFÉ</b>	<i>Janet Morison</i>	680687	
<b>PARENT BABY &amp; TODDLER</b>	<i>Vikki Daley</i>	680138	
<b>HEMYOCK PRE-SCHOOL</b>	<i>Pre-School Administrator</i>	680240	
<b>PRIMARY SCHOOL</b>	<i>Administration</i>	680240	
<b>SCOUTS</b>	<i>Andy Batten GSL</i>	01884 841607	hemyock.scoutsites.org.uk
	<i>Karen Pinder Group Executive Chair</i>	681034	
<b>CUB SCOUTS</b>	<i>Julie Betteridge</i>	07510 190370	
<b>SHORT MAT BOWLS</b>	<i>Doreen Perrott</i>	680850	
<b>SNOOKER CLUB</b>	<i>Mr L Bowden</i>	680106	
<b>ST MARY'S CHURCH</b>	<i>Mr B Samuels (Sec)</i>	664729	
<b>ST MARY'S RINGERS</b>	<i>Mrs L Holway</i>	681522	
<b>STROKE CLUB</b>	<i>Patrick Holman</i>	680004	
<b>TUESDAY GROUP</b>	<i>Diane Denman</i>	680139	
<b>VALLEY ARTS &amp; SOCIAL SOCIETY</b>	<i>Mrs C Pinder</i>	680854	
<b>WALK AND TALK</b>	<i>Penny Scoynes, Health Walk Co-ordinator</i>	01392 824752	
<b>YOUNG FARMERS</b>	<i>Michelle Batting</i>	07738 114113	

